



Core & Coil (71A) MH 175W – 450W

CORE & COIL HID MH BAL 400W M59 QUAD C&C

The basic ballast is the open core and coil which is most often used as a component within a lighting luminaire. The core and coil also forms the nucleus of Philips Advance's five other ballast configurations.

Product data

General Information			
ANSI Code	M59	Input Frequency	60 Hz
Lamp Type	400W MH	Inp. Current (Open Circuit)	3/1.8/1.5/1.35 A
Number of Lamps	1 piece/unit	Input Current (Starting)	3.25/1.9/1.65/1.45 A
Circuit Type	CWA	Input Current (Short Circuit)	2.54–3.81/1.46–2.19/1.27–1.9/1.1–1.66 A
Ballast Type	Magnetic HID	Secondary Short Circuit Current	3.43–4.19 A
Base Model	71A6091A	Constant Wattage Deviation	10%
Core Size	4 1/4 x 4 3/4 (2 coil)	Ballast Factor (Nom)	1
Suitable For Outdoor Use	Yes	Power Factor (Nom)	0.90
Ignitor Catalog Number	NA	Nominal Open Circuit Voltage	305 V
Ignitor Temperature Rating	NA	Input Current (Operating) (Nom)	4/2.3/2/1.72 A A
Capacitor Value	24 MFD	Input Power (Nom)	455 W
Capacitor Catalog Number	7C240P40R	Rated Lamp Watts	400 W
Capacitor Requirements	400V		
Capacitor Temperature Rating	105°C		
Capacitor Diameter/Oval Dimensions	1.75 in		
Capacitor Height	4.8 in		
Automatic Restart	No		
Operating and Electrical		Wiring	
Input Voltage	120/208/240/277 V	Wire Striplength	0.5 mm
		Wire Length by Color	12"
		Wire Type	Stranded
		Remote Wiring Configuration Allowed	Yes
		Max Ballast-Lamp Distance Remote Wiring	Determined by AWG used
		Recommended Fuse Value	10/7/5/5 A

Core & Coil (71A) MH 175W - 450W

Approval and Application

Open Circuit Voltage Test (Volts)	275-335 V
Approbation Marks	ULR CSA certificate RoHS Compliant
Temperature Marking	D/E/D/E
UL Recognized	Yes
Hipot Test (1 Minute)	2000 V
Hipot Test (2 Seconds)	2500 V
UL Insulation Class	H(180°C)
UL Temperature Code	1029E

Product Data

Order product name	CORE & COIL HID 71A6091510DA
EAN/UPC - Product	781087053447
Order code	71A6091510DA
Numerator - Quantity Per Pack	1
Numerator - Packs per outer box	3
Material Nr. (12NC)	913710467110
Net Weight (Piece)	5.131 kg

Dimensional drawing

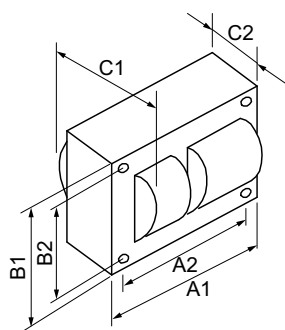

MH BAL 400W M59/H33 QUAD C&C

Product	C1	C2	A1	A2	B1	B2
CORE & COIL HID 71A6091510DA	4 in	2.13 in	4.8 in	4.4 in	4.3 in	3.9 in

