



# Core & Coil (71A) HPS ~LT~ 200W

## CORE & COIL HID HPS BAL 150W S55 480V C&C

The basic ballast is the open core and coil which is most often used as a component within a lighting luminaire. The core and coil also forms the nucleus of Philips Advance's five other ballast configurations.

### Product data

General Information			
ANSI Code	S55	Input Frequency	60 Hz
Lamp Type	150W HPS	Inp. Current (Open Circuit)	0.7 A
Number of Lamps	1 piece/unit	Input Current (Starting)	0.5 A
Circuit Type	HX-HPF	Input Current (Short Circuit)	0.3-0.45 A
Ballast Type	Magnetic HID	Secondary Short Circuit Current	3.95-4.85 A
Base Model	71A8142	Constant Wattage Deviation	Within Trapezoid
Core Size	3 X 4 (2 coil)	Ballast Factor (Nom)	1
Suitable For Outdoor Use	Yes	Power Factor (Nom)	0.90
Ignitor Catalog Number	LI551-H4	Nominal Open Circuit Voltage	120 V
Ignitor Temperature Rating	105°C	Input Current (Operating) (Nom)	0.42 A A
Capacitor Value	14 MFD	Input Power (Nom)	188 W
Capacitor Catalog Number	7C140M30RA	Rated Lamp Watts	150 W
Capacitor Requirements	280V	Wiring	
Capacitor Temperature Rating	105°C	Wire Striplength	0.5 mm
Capacitor Diameter/Oval Dimensions	1.65 in	Wire Length by Color	12"
Capacitor Height	2.75 in	Wire Type	Stranded
Automatic Restart	No	Remote Wiring Configuration Allowed	Yes
Operating and Electrical		Max Ballast-Lamp Distance Remote Wiring	2'
Input Voltage	480 V	Recommended Fuse Value	2 A

## Core & Coil (71A) HPS ~LT~ 200W

### Approval and Application

Open Circuit Voltage Test (Volts)	110-130 V
Approbation Marks	ULR CSA certificate RoHS Compliant
Temperature Marking	E
UL Recognized	Yes
Hipot Test (1 Minute)	2000 V
Hipot Test (2 Seconds)	2500 V
UL Insulation Class	H(180°C)
UL Temperature Code	1029E

### Product Data

Order product name	CORE & COIL HID HPS BAL 150W S55 480V C&C
--------------------	---

EAN/UPC - Product	781087030165
Order code	71A8142510D
Numerator - Quantity Per Pack	1
Numerator - Packs per outer box	4
Material Nr. (12NC)	913710470002
Net Weight (Piece)	4.305 kg

### Dimensional drawing

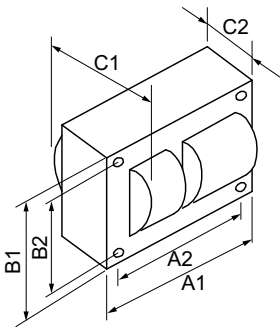

HPS BAL 150W S55 480V C&C

Product	C1	C2	A1	A2	B1	B2
CORE & COIL HID 71A8142510D	4.3 in	3 in	3.9 in	3.5 in	2.8 in	2.4 in

