

Core & Coil (71A) HPS ~LT~ 200W

The basic ballast is the open core and coil which is most often used as a component within a lighting luminaire. The core and coil also forms the nucleus of Philips Advance's five other ballast configurations.

Product data

General Information			
ANSI Code	S56	Input current (short circuit)	0.8-1.2/0.45-0.7/0.4-0.6/0.35-0.55 A
Lamp type	150W HPS	Secondary short-circuit current	2.2-2.7 A
Number of lamps	1 piece/unit	Constant wattage deviation	Within Trapezoid
Circuit type	CWA	Ballast factor (nom.)	1
Ballast type	Magnetic HID	Power factor (nom.)	0.90
Base model	71A8196	Open circuit voltage	180 V
Core size	3 X 4 (2 coil)	Input current (nom.)	1.75/1/0.88/0.75 A A
Suitable for outdoor use	Yes	Input power (nom.)	188 W
Ignitor catalogue number	LI501-H4	Rated lamp power	150 W
Ignitor temperature rating	105°C		
Capacitor value	20 MFD	Wiring	
Capacitor catalogue number	7C200P30RA	Wire strip length	0.5 mm
Capacitor requirements	280V	Wire length by colour	12"
Capacitor temperature rating	105°C	Wire type	Stranded
Capacitor diameter/oval dimensions	1.58 in	Remote wiring configuration allowed	Yes
Capacitor height	3.62 in	Max. ballast-lamp distance remote wiring	2'
Automatic restart	No	Recommended fuse value	5/3/3/3 A
Operating and Electrical			
Input voltage	120/208/240/277 V	Approval and Application	
Input frequency	60 Hz	Open circuit voltage test (volts)	165-200 V
Input current (open circuit)	0.8/0.5/0.4/0.35 A	Approval marks	ULR CSA certificate RoHS Compliant
Input current (starting)	1.2/0.7/0.6/0.5 A	Temperature marking	E/D/C/C
		UL recognised	Yes
		Hipot test (1 minute)	2000 V

Core & Coil (71A) HPS ~LT~ 200W

Hipot test (2 seconds)	2500 V
UL insulation class	H(180°C)
UL temperature code	1029E

Product Data

Order product name	CORE & COIL HID 71A8196510D
EAN/UPC – product	781087031186

Numerator – quantity per pack	1
Numerator – packs per outer box	4
Material no. (12NC)	913710470602
Net weight (piece)	3.552 kg

Dimensional drawing

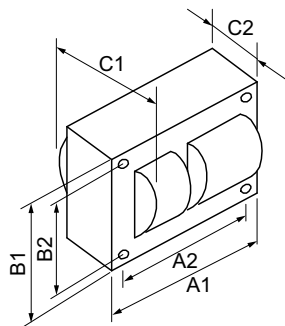

HPS BAL 150W S56 QUAD C&C

Product	C1	C2	A1	A2	B1	B2
CORE & COIL HID 71A8196510D	4.1 in	2.5 in	3.9 in	3.5 in	2.8 in	2.4 in

