

Core & Coil (71A) HPS ~LT~ 200W

CORE & COIL HID HPS BAL 150W S56 QUAD C&C

The basic ballast is the open core and coil which is most often used as a component within a lighting luminaire. The core and coil also forms the nucleus of Philips Advance's five other ballast configurations.

Product data

General Information			
ANSI Code	S56	Input Frequency	60 Hz
Lamp Type	150W HPS	Inp. Current (Open Circuit)	0.8/0.5/0.4/0.35 A
Number of Lamps	1 piece/unit	Input Current (Starting)	1.2/0.7/0.6/0.5 A
Circuit Type	CWA	Input Current (Short Circuit)	0.8-1.2/0.45-0.7/0.4-0.6/0.35-0.55 A
Ballast Type	Magnetic HID	Secondary Short Circuit Current	2.2-2.7 A
Base Model	71A8196	Constant Wattage Deviation	Within Trapezoid
Core Size	3 X 4 (2 coil)	Ballast Factor (Nom)	1
Suitable For Outdoor Use	Yes	Power Factor (Nom)	0.90
Ignitor Catalog Number	LI501-H4	Nominal Open Circuit Voltage	180 V
Ignitor Temperature Rating	105°C	Input Current (Operating) (Nom)	1.75/1/0.88/0.75 A A
Capacitor Value	20 MFD	Input Power (Nom)	188 W
Capacitor Catalog Number	7C200P30RA	Rated Lamp Watts	150 W
Capacitor Requirements	280V	Wiring	
Capacitor Temperature Rating	105°C	Wire Striplength	0.5 mm
Capacitor Diameter/Oval Dimensions	1.58 in	Wire Length by Color	12"
Capacitor Height	3.62 in	Wire Type	Stranded
Automatic Restart	No	Remote Wiring Configuration Allowed	Yes
Operating and Electrical		Max Ballast-Lamp Distance Remote Wiring	2'
Input Voltage	120/208/240/277 V	Recommended Fuse Value	5/3/3/3 A

Core & Coil (71A) HPS ~LT~ 200W

Approval and Application

Open Circuit Voltage Test (Volts)	165-200 V
Approbation Marks	ULR CSA certificate RoHS Compliant
Temperature Marking	E/D/C/C
UL Recognized	Yes
Hipot Test (1 Minute)	2000 V
Hipot Test (2 Seconds)	2500 V
UL Insulation Class	H(180°C)
UL Temperature Code	1029E

Product Data

Order product name	CORE & COIL HID 71A8196510D
EAN/UPC - Product	781087031186
Order code	71A8196510D
Numerator - Quantity Per Pack	1
Numerator - Packs per outer box	4
Material Nr. (12NC)	913710470602
Net Weight (Piece)	3.552 kg

Dimensional drawing

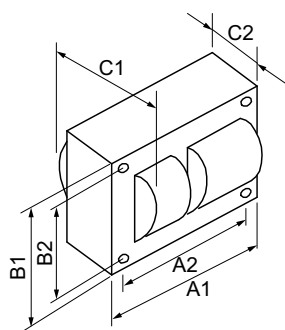

HPS BAL 150W S56 QUAD C&C

Product	C1	C2	A1	A2	B1	B2
CORE & COIL HID 71A8196510D	4.1 in	2.5 in	3.9 in	3.5 in	2.8 in	2.4 in

