

Core & Coil (71A) MH ~LT~ 175W

**CORE & COIL HID MH BAL 100W M90/140 QUAD
C&C**

The basic ballast is the open core and coil which is most often used as a component within a lighting luminaire. The core and coil also forms the nucleus of Philips Advance's five other ballast configurations.

Product data

General Information	
ANSI Code	M90-M140
Lamp Type	100 MH
Number of Lamps	1 piece/unit
Circuit Type	HX-HPF
Ballast Type	Magnetic HID
Base Model	71A5390
Core Size	3 X 4 (2 LW)
Suitable For Outdoor Use	Yes
Ignitor Catalog Number	LI533-H4
Ignitor Temperature Rating	105°C
Capacitor Value	12 MFD
Capacitor Catalog Number	7C120M30RA
Capacitor Requirements	280V
Capacitor Temperature Rating	105°C
Capacitor Diameter/Oval	1.65 in
Dimensions	
Capacitor Height	2.75 in
Automatic Restart	No

Operating and Electrical	
Input Voltage	120/208/240/277 V
Input Frequency	60 Hz
Inp. Current (Open Circuit)	2.5/1.5/1.3/1.12 A
Input Current (Starting)	1.24/0.54/0.45/0.4 A
Input Current (Short Circuit)	0.63-0.95/0.43-0.65/0.37-0.55/0.29-0.44 A
Secondary Short Circuit Current	1.35-1.7 A
Constant Wattage Deviation	12%
Ballast Factor (Nom)	1
Power Factor (Nom)	0.90
Nominal Open Circuit Voltage	260 V
Input Current (Operating) (Nom)	1.15/0.66/0.58/0.5 A A
Input Power (Nom)	129 W
Rated Lamp Watts	100 W
Wiring	
Wire Striplength	0.5 mm
Wire Length by Color	12"
Wire Type	Stranded

Core & Coil (71A) MH ~LT~ 175W

Remote Wiring Configuration	Yes
Allowed	
Max Ballast-Lamp Distance	20'
Remote Wiring	
Recommended Fuse Value	10/5/5/4 A

Approval and Application

Open Circuit Voltage Test (Volts)	240-300 V
Approbation Marks	ULR CSA certificate NOM certificate RoHS Compliant
Temperature Marking	B/B/A/A
UL Recognized	Yes
Hipot Test (1 Minute)	2000 V
Hipot Test (2 Seconds)	2500 V

UL Insulation Class	H(180°C)
UL Temperature Code	1029B

Product Data

Order product name	CORE & COIL HID MH BAL 100W M90/140 QUAD C&C
EAN/UPC - Product	781087041963
Order code	71A5390500DML
Numerator - Quantity Per Pack	1
Numerator - Packs per outer box	2
Material Nr. (12NC)	913710489909
Net Weight (Piece)	2.654 kg

Dimensional drawing

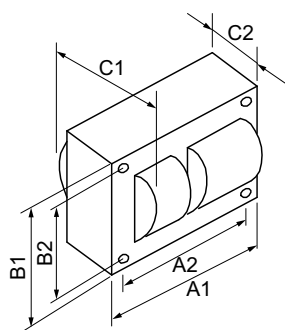

MH BAL 100W M90/140 QUAD C&C

Product	C1	C2	A1	A2	B1	B2
CORE & COIL HID 71A5390500DML	3.07 in	1.5 in	3.9 in	3.5 in	2.8 in	2.4 in

