

Core & Coil (71A) MH ~LT~ 175W

**CORE & COIL HID MH BAL 100W M90/140
127/220V C&C**

The basic ballast is the open core and coil which is most often used as a component within a lighting luminaire. The core and coil also forms the nucleus of Philips Advance's five other ballast configurations.

Product data

| General Information | |
|------------------------------------|----------------|
| ANSI Code | M90-M140 |
| Lamp Type | 100 MH |
| Number of Lamps | 1 piece/unit |
| Circuit Type | HX-HPF |
| Ballast Type | Magnetic HID |
| Base Model | 71A53H0 |
| Core Size | 3 X 4 (2 coil) |
| Suitable For Outdoor Use | Yes |
| Ignitor Catalog Number | LI533-H4 |
| Ignitor Temperature Rating | 105°C |
| Capacitor Value | 12 MFD |
| Capacitor Catalog Number | 7C120M30RA |
| Capacitor Requirements | 280V |
| Capacitor Temperature Rating | 105°C |
| Capacitor Diameter/Oval Dimensions | 1.65 in |
| Capacitor Height | 2.75 in |
| Automatic Restart | No |
| | |

Operating and Electrical

| | |
|---------------------------------|-----------------------|
| Input Voltage | 127/220 V |
| Input Frequency | 60 Hz |
| Inp. Current (Open Circuit) | 2.2/1.3 A |
| Input Current (Starting) | 1.25/0.9 A |
| Input Current (Short Circuit) | 0.75-1.15/0.35-0.65 A |
| Secondary Short Circuit Current | 1.3-1.6 A |
| Constant Wattage Deviation | 12% |
| Ballast Factor (Nom) | 1 |
| Power Factor (Nom) | 0.90 |
| Nominal Open Circuit Voltage | 280 V |
| Input Current (Operating) (Nom) | 1/0.64 A A |
| Input Power (Nom) | 129 W |
| Rated Lamp Watts | 100 W |

Wiring

| | |
|-------------------------------------|----------|
| Wire Striplength | 0.5 mm |
| Wire Length by Color | 12" |
| Wire Type | Stranded |
| Remote Wiring Configuration Allowed | Yes |

Core & Coil (71A) MH ~LT~ 175W

| | |
|---|--|
| Max Ballast-Lamp Distance Remote Wiring | 25' |
| Recommended Fuse Value | 5/3 A |
| Approval and Application | |
| Open Circuit Voltage Test (Volts) | 250-315 V |
| Approbation Marks | NOM certificate RoHS Compliant CSA certificate |
| Temperature Marking | A/B |
| UL Recognized | Yes |
| Hipot Test (1 Minute) | 2000 V |
| Hipot Test (2 Seconds) | 2500 V |
| UL Insulation Class | H(180°C) |
| UL Temperature Code | 1029B |

Product Data

| | |
|---------------------------------|--|
| Order product name | CORE & COIL HID MH BAL 100W M90/140 127/220V C&C |
| EAN/UPC - Product | 781087034743 |
| Order code | 71A53H0500DML |
| Numerator - Quantity Per Pack | 1 |
| Numerator - Packs per outer box | 2 |
| Material Nr. (12NC) | 913710490702 |
| Net Weight (Piece) | 2.672 kg |

Dimensional drawing

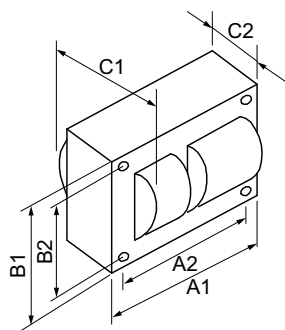

MH BAL 100W M90/140 127/220V C&C

| Product | C1 | C2 | A1 | A2 | B1 | B2 |
|--|--------|--------|--------|--------|--------|--------|
| CORE & COIL HID MH BAL 100W M90/140 127/220V C&C | 2.9 in | 1.7 in | 3.9 in | 3.5 in | 2.8 in | 2.4 in |

