



## Core & Coil (71A) MH

**CORE & COIL HID MH BAL 250W M58/H37 QUAD  
C&C**

The basic ballast is the open core and coil which is most often used as a component within a lighting luminaire. The core and coil also forms the nucleus of Philips Advance's five other ballast configurations.

## Product data

General Information	
ANSI Code	M58
Lamp Type	250W MH
Number of Lamps	1 piece/unit
Circuit Type	CWA
Ballast Type	Magnetic HID
Base Model	71A5790A
Core Size	4 1/4 x 4 3/4 (2 coil)
Suitable For Outdoor Use	Yes
Ignitor Catalog Number	NA
Ignitor Temperature Rating	NA
Capacitor Value	15 MFD
Capacitor Catalog Number	7C150P40R
Capacitor Requirements	400V
Capacitor Temperature Rating	105°C
Capacitor Diameter/Oval Dimensions	1.75 in
Capacitor Height	3.75 in
Automatic Restart	No

Operating and Electrical	
Input Voltage	120/208/240/277 V
Input Frequency	60 Hz
Input Current (Open Circuit)	1.7/1/0.85/0.75 A
Input Current (Starting)	2.2/1.3/1.1/1 A
Input Current (Short Circuit)	1.9-2.7/1.1-1.7/0.95-1.35/0.8-1.2 A
Secondary Short Circuit Current	2.25-2.75 A
Constant Wattage Deviation	10%
Ballast Factor (Nom)	1
Power Factor (Nom)	0.90
Open Circuit Voltage	300 V
Input Current (Nom)	2.5/1.45/1.25/1.1 A A
Input Power (Nom)	298 W
Rated Lamp Power	250 W
Wiring	
Wire Striplength	0.5 mm
Wire Length by Color	12"
Wire Type	Stranded
Remote Wiring Configuration Allowed	Yes

## Core & Coil (71A) MH 175W - 450W

Max Ballast-Lamp Distance Remote	Determined by AWG used
Wiring	
Recommended Fuse Value	8/5/5/3 A
<b>Approval and Application</b>	
Open Circuit Voltage Test (Volts)	270-330 V
Approval Marks	ULR NOM certificate RoHS Compliant CSA certificate
Temperature Marking	B/B/B/B
UL Recognized	No
Hipot Test (1 Minute)	2000 V
Hipot Test (2 Seconds)	2500 V
UL Insulation Class	H(180°C)
UL Temperature Code	1029B

<b>Product Data</b>	
Order product name	CORE & COIL HID MH BAL 250W M58/H37 QUAD C&C
EAN/UPC - Product	781087055069
Order code	120501
Local order code	120501
Numerator - Quantity Per Pack	1
Numerator - Packs per outer box	4
Material Nr. (12NC)	913710498910
Net Weight (Piece)	4.115 kg

### Dimensional drawing

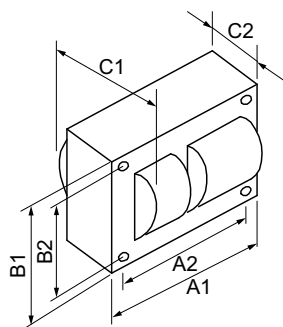

MH BAL 250W M58/H37 QUAD C&C

Product	C1	C2	A1	A2	B1	B2
CORE & COIL HID MH BAL 250W M58/H37 QUAD C&C	3.15 in	1.5 in	4.8 in	4.4 in	4.3 in	3.9 in

