

Core & Coil (71A) MH

175W - 450W

**CORE & COIL HID MH BAL 320W M132/M154
QUAD C&C**

The basic ballast is the open core and coil which is most often used as a component within a lighting luminaire. The core and coil also forms the nucleus of Philips Advance's five other ballast configurations.

Product data

| General Information | |
|------------------------------------|------------------------|
| ANSI Code | M132-M154 |
| Lamp Type | 320W MH |
| Number of Lamps | 1 piece/unit |
| Circuit Type | SUPER-CWA |
| Ballast Type | Magnetic HID |
| Base Model | 71A5892A |
| Core Size | 4 1/4 x 4 3/4 (2 coil) |
| Suitable For Outdoor Use | Yes |
| Ignitor Catalog Number | LI533-H4 |
| Ignitor Temperature Rating | 105°C |
| Capacitor Value | 21 MFD |
| Capacitor Catalog Number | 7C210P40R |
| Capacitor Requirements | 400V |
| Capacitor Temperature Rating | 105°C |
| Capacitor Diameter/Oval Dimensions | 1.75 in |
| Capacitor Height | 4.80 in |
| Automatic Restart | No |

Operating and Electrical

| | |
|---------------------------------|-----------------------------------|
| Input Voltage | 120/208/240/277 V |
| Input Frequency | 60 Hz |
| Input Current (Open Circuit) | 2.3/1.35/1.15/1 A |
| Input Current (Starting) | 2.1/1.2/1.05/0.95 A |
| Input Current (Short Circuit) | 1.65-2.5/1-1.5/0.8-1.25/0.7-1.1 A |
| Secondary Short Circuit Current | 2.9-3.6 A |
| Constant Wattage Deviation | 10% |
| Ballast Factor (Nom) | 1 |
| Power Factor (Nom) | 0.90 |
| Open Circuit Voltage | 270 V |
| Input Current (Nom) | 3.25/1.9/1.65/1.4 A A |
| Input Power (Nom) | 368 W |
| Rated Lamp Power | 320 W |

Wiring

| | |
|-------------------------------------|----------|
| Wire Striplength | 0.5 mm |
| Wire Length by Color | 12" |
| Wire Type | Stranded |
| Remote Wiring Configuration Allowed | Yes |

Core & Coil (71A) MH 175W - 450W

| | |
|---|--|
| Max Ballast-Lamp Distance Remote Wiring | 2' |
| Recommended Fuse Value | 8/6/5/3 A |
| Approval and Application | |
| Open Circuit Voltage Test (Volts) | 250-300 V |
| Approval Marks | ULR CSA certificate NOM certificate RoHS Compliant |
| Temperature Marking | B/B/B/B |
| UL Recognized | Yes |
| Hipot Test (1 Minute) | 2000 V |
| Hipot Test (2 Seconds) | 2500 V |
| UL Insulation Class | H(180°C) |

| | |
|---------------------------------|--|
| UL Temperature Code | 1029B |
| Product Data | |
| Order product name | CORE & COIL HID MH BAL 320W M132/M154 QUAD C&C |
| EAN/UPC - Product | 781087054659 |
| Order code | 913710501809 |
| Numerator - Quantity Per Pack | 1 |
| Numerator - Packs per outer box | 2 |
| Material Nr. (12NC) | 913710501809 |
| Net Weight (Piece) | 5.249 kg |

Dimensional drawing

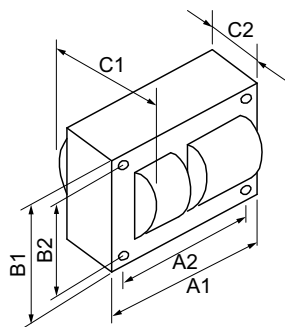

MH BAL 320W M132/M154 QUAD C&C

| Product | C1 | C2 | A1 | A2 | B1 | B2 |
|--|---------|--------|--------|--------|--------|--------|
| CORE & COIL HID MH BAL 320W M132/M154 QUAD C&C | 3.65 in | 1.8 in | 4.8 in | 4.4 in | 4.3 in | 3.9 in |

