



# Core & Coil (71A) MH 175W - 450W

## CORE & COIL HID MH BAL 320W M132/154 120/277/347V C&C

The basic ballast is the open core and coil which is most often used as a component within a lighting luminaire. The core and coil also forms the nucleus of Philips Advance's five other ballast configurations.

### Product data

General Information		Operating and Electrical	
ANSI Code	M132-M154	Input Voltage	120/277/347 V
Lamp Type	320W MH	Input Frequency	60 Hz
Number of Lamps	1 piece/unit	Input Current (Open Circuit)	2.6/1.1/0.9 A
Circuit Type	SUPER-CWA	Input Current (Starting)	2.2/0.95/0.7 A
Ballast Type	Magnetic HID	Input Current (Short Circuit)	1.6-2.55/0.7-1.1/0.55-0.85 A
Base Model	71A58A2A	Secondary Short Circuit Current	2.9-3.6 A
Core Size	4 1/4 x 4 3/4 (2 coil)	Constant Wattage Deviation	10%
Suitable For Outdoor Use	Yes	Ballast Factor (Nom)	1
Ignitor Catalog Number	LI533-H4	Power Factor (Nom)	0.90
Ignitor Temperature Rating	105°C	Open Circuit Voltage	280 V
Capacitor Value	21 MFD	Input Current (Nom)	3.25/1.4/1.1 A A
Capacitor Catalog Number	7C210P40R	Input Power (Nom)	368 W
Capacitor Requirements	400V	Rated Lamp Power	320 W
Capacitor Temperature Rating	105°C		
Capacitor Diameter/Oval Dimensions	1.75 in	Wiring	
Capacitor Height	4.80 in	Wire Striplength	0.5 mm
Automatic Restart	No	Wire Length by Color	12"
		Wire Type	Stranded
		Remote Wiring Configuration Allowed	Yes

## Core & Coil (71A) MH 175W - 450W

Max Ballast-Lamp Distance Remote	2'
Wiring	
Recommended Fuse Value	8/4/3 A
<b>Approval and Application</b>	
Open Circuit Voltage Test (Volts)	260-310 V
Approval Marks	ULR CSA certificate RoHS Compliant
Temperature Marking	C/C/C
UL Recognized	Yes
Hipot Test (1 Minute)	2000 V
Hipot Test (2 Seconds)	2500 V
UL Insulation Class	H(180°C)
UL Temperature Code	1029C

<b>Product Data</b>	
Order product name	CORE & COIL HID MH BAL 320W M132/154 120/277/347V C&C
EAN/UPC - Product	781087042762
Order code	120550
Local order code	120550
Numerator - Quantity Per Pack	1
Numerator - Packs per outer box	4
Material Nr. (12NC)	913710577402
Net Weight (Piece)	4.523 kg

### Dimensional drawing

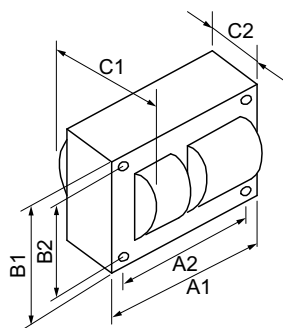

MH BAL 320W M132/154 120/277/347V C&C

Product	C1	C2	A1	A2	B1	B2
CORE & COIL HID 71A58A2500DA	3.65 in	1.8 in	4.8 in	4.4 in	4.3 in	3.9 in

