



# Core & Coil (71A) MH ~GT~ 450W

## CORE & COIL HID MH BAL 750W M149 347/480V/120T C&C

The basic ballast is the open core and coil which is most often used as a component within a lighting luminaire. The core and coil also forms the nucleus of Philips Advance's five other ballast configurations.

### Product data

| General Information                |                        |
|------------------------------------|------------------------|
| ANSI Code                          | M149                   |
| Lamp Type                          | 750W MH                |
| Number of Lamps                    | 1 piece/unit           |
| Circuit Type                       | SUPER-CWA              |
| Ballast Type                       | Magnetic HID           |
| Base Model                         | 71A64F0T               |
| Core Size                          | 4 1/4 x 4 3/4 (2 coil) |
| Suitable For Outdoor Use           | Yes                    |
| Ignitor Catalog Number             | LI573-H5               |
| Ignitor Temperature Rating         | 105°C                  |
| Capacitor Value                    | 28 MFD                 |
| Capacitor Catalog Number           | 7C280S40               |
| Capacitor Requirements             | 400V                   |
| Capacitor Temperature Rating       | 105°C                  |
| Capacitor Diameter/Oval Dimensions | 2 in                   |
| Capacitor Height                   | 4.8 in                 |
| Automatic Restart                  | No                     |

| Operating and Electrical        |                      |
|---------------------------------|----------------------|
| Input Voltage                   | 347/480/120T V       |
| Input Frequency                 | 60 Hz                |
| Input Current (Open Circuit)    | 1.35/1 A             |
| Input Current (Starting)        | 1.8/1.4 A            |
| Input Current (Short Circuit)   | 1.45–2.15/1.1–1.65 V |
| Secondary Short Circuit Current | 4.9–6 A              |
| Constant Wattage Deviation      | 10%                  |
| Ballast Factor (Nom)            | 1                    |
| Power Factor (Nom)              | 0.90                 |
| Open Circuit Voltage            | 340 V                |
| Input Current (Nom)             | 2.5/1.75 A A         |
| Input Power (Nom)               | 820 W                |
| Rated Lamp Power                | 750 W                |

| Wiring                              |          |
|-------------------------------------|----------|
| Wire Striplength                    | 0.5 mm   |
| Wire Length by Color                | 12"      |
| Wire Type                           | Stranded |
| Remote Wiring Configuration Allowed | Yes      |

## Core & Coil (71A) MH ~GT~ 450W

|   |                                    |
|---|------------------------------------|
| Max Ballast-Lamp Distance Remote Wiring | 15'                                |
| Recommended Fuse Value                  | 6/4 A                              |
| <b>Approval and Application</b>         |                                    |
| Open Circuit Voltage Test (Volts)       | 306-375 V                          |
| Approval Marks                          | ULR CSA certificate RoHS Compliant |
| Temperature Marking                     | A/A                                |
| UL Recognized                           | Yes                                |
| Hipot Test (1 Minute)                   | 1500 V                             |
| Hipot Test (2 Seconds)                  | 2500 V                             |
| UL Insulation Class                     | N(AC200°C)                         |
| UL Temperature Code                     | 1029A                              |

|                                 |   |
|---------------------------------|---|
| <b>Product Data</b>             |   |
| Order product name              | CORE & COIL HID MH BAL 750W M149<br>347/480V/120T C&C |
| EAN/UPC - Product               | 781087044131  |
| Order code                      | 197491  |
| Local order code                | 197491  |
| Numerator - Quantity Per Pack   | 1   |
| Numerator - Packs per outer box | 3   |
| Material Nr. (12NC)             | 913710582002  |
| Net Weight (Piece)              | 6.428 kg  |

### Dimensional drawing

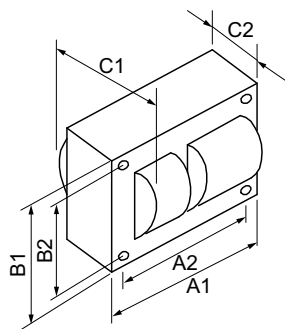

MH BAL 750W M149 347/480V/120T C&C

| Product                     | C1     | C2   | A1     | A2     | B1     | B2     |
|-----------------------------|--------|------|--------|--------|--------|--------|
| CORE & COIL HID 71A64F0600T | 4.9 in | 3 in | 4.8 in | 4.4 in | 4.3 in | 3.9 in |

