

Core & Coil (71A) MH ~GT~ 450W

CORE & COIL HID MH BAL 875W M166 QUAD C&C

The basic ballast is the open core and coil which is most often used as a component within a lighting luminaire. The core and coil also forms the nucleus of Philips Advance's five other ballast configurations.

Product data

General Information			
ANSI Code	M166	Input Frequency	60 Hz
Lamp Type	875W MH	Inp. Current (Open Circuit)	3.75/2.1/2.05/1.7 A
Number of Lamps	1 piece/unit	Input Current (Starting)	6.4/3.65/3.2/2.8 A
Circuit Type	SUPER-CWA	Input Current (Short Circuit)	4.6-7/2.6-4/2.25-3.45/2-3 V
Ballast Type	Magnetic HID	Secondary Short Circuit Current	4.45-5.4 A
Base Model	71A6498	Constant Wattage Deviation	10%
Core Size	4 1/4 x 4 3/4 (2 coil)	Ballast Factor (Nom)	1
Suitable For Outdoor Use	Yes	Power Factor (Nom)	0.90
Ignitor Catalog Number	LI572-H5	Nominal Open Circuit Voltage	415 V
Ignitor Temperature Rating	105°C	Input Current (Operating) (Nom)	7.75/4.3/3.9/3.35 A A
Capacitor Value	21 MFD	Input Power (Nom)	940 W
Capacitor Catalog Number	MD2100030	Rated Lamp Watts	875 W
Capacitor Requirements	480V	Wiring	
Capacitor Temperature Rating	90°C	Wire Striplength	0.5 mm
Capacitor Diameter/Oval Dimensions	1.75 in	Wire Length by Color	12"
Capacitor Height	3.9 in	Wire Type	Stranded
Automatic Restart	No	Remote Wiring Configuration Allowed	Yes
Operating and Electrical		Max Ballast-Lamp Distance Remote	5'
Input Voltage	120/208/240/277 V	Wiring	

Core & Coil (71A) MH ~GT~ 450W

Recommended Fuse Value	20/10/10/8 A
Approval and Application	
Open Circuit Voltage Test (Volts)	375-455 V
Approbation Marks	ULR CSA certificate RoHS Compliant
Temperature Marking	E/E/E/E
UL Recognized	Yes
Hipot Test (1 Minute)	1500 V
Hipot Test (2 Seconds)	2500 V
UL Insulation Class	H(180°C)
UL Temperature Code	1029E

Product Data	
Order product name	CORE & COIL HID MH BAL 875W M166 QUAD C&C
EAN/UPC - Product	781087044179
Order code	71A6498500
Numerator - Quantity Per Pack	1
Numerator - Packs per outer box	2
Material Nr. (12NC)	913710582302
Net Weight (Piece)	0.010 kg

Dimensional drawing

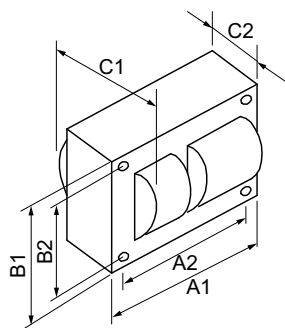

Product	C1	C2	A1	A2	B1	B2
CORE & COIL HID 71A6498500	5 in	3 in	4.8 in	4.4 in	4.3 in	3.9 in

MH BAL 875W QUAD C&C

