



Core & Coil (71A) HPS ~LT~ 200W

**CORE & COIL HID HPS BAL 150W S55 220/240V
C&C**

The basic ballast is the open core and coil which is most often used as a component within a lighting luminaire. The core and coil also forms the nucleus of Philips Advance's five other ballast configurations.

Product data

General Information	
ANSI Code	S55
Lamp Type	150W HPS
Number of Lamps	1 piece/unit
Circuit Type	CWA
Ballast Type	Magnetic HID
Base Model	71A81J9
Core Size	4 x 4 (2 coil)
Suitable For Outdoor Use	Yes
Ignitor Catalog Number	LI551-J4
Ignitor Temperature Rating	105°C
Capacitor Value	60 MFD
Capacitor Catalog Number	7C600P24RT1
Capacitor Requirements	240V
Capacitor Temperature Rating	105°C
Capacitor Diameter/Oval Dimensions	1.62 in
Capacitor Height	3.62 in
Automatic Restart	No

Operating and Electrical

Input Voltage	220/240 V
Input Frequency	60 Hz
Input Current (Open Circuit)	0.36/0.32 A
Input Current (Starting)	0.46/0.42 A
Input Current (Short Circuit)	0.37-0.55/0.33-0.5 A
Secondary Short Circuit Current	3.95-4.8 A
Constant Wattage Deviation	Within Trapezoid
Ballast Factor (Nom)	1
Power Factor (Nom)	0.90
Open Circuit Voltage	110 V
Input Current (Nom)	0.79/0.74 A A
Input Power (Nom)	170 W
Rated Lamp Power	150 W

Wiring

Wire Striplength	0.5 mm
Wire Length by Color	12"
Wire Type	Stranded
Remote Wiring Configuration Allowed	Yes

Core & Coil (71A) HPS ~LT~ 200W

Max Ballast-Lamp Distance Remote Wiring 2'	
Recommended Fuse Value	2/2 A
Approval and Application	
Open Circuit Voltage Test (Volts)	100-122 V
Approval Marks	FIDE Certificate NOM certificate RoHS Compliant
Temperature Marking	A/A
UL Recognized	No
Hipot Test (1 Minute)	2000 V
Hipot Test (2 Seconds)	2500 V
UL Insulation Class	H(180°C)
UL Temperature Code	1029A

Product Data	
Order product name	CORE & COIL HID HPS BAL 150W S55 220/240V C&C
EAN/UPC - Product	781087039366
Order code	913710591910
Numerator - Quantity Per Pack	1
Numerator - Packs per outer box	2
Material Nr. (12NC)	913710591910
Net Weight (Piece)	6.110 kg

Dimensional drawing

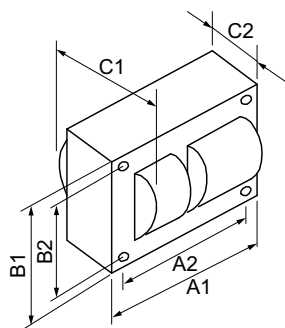

HPS BAL 150W S55 220/240V C&C

Product	C1	C2	A1	A2	B1	B2
CORE & COIL HID 71A81J9500DML	3.90 in	2.15 in	4.8 in	4.4 in	4.3 in	3.9 in

