



# Core & Coil (71A) HPS 200W - 400W

## CORE & COIL HID 71A82J9500DML

The basic ballast is the open core and coil which is most often used as a component within a lighting luminaire. The core and coil also forms the nucleus of Philips Advance's five other ballast configurations.

### Product data

General Information	
ANSI Code	S50
Lamp Type	250W HPS
Number of Lamps	1 piece/unit
Circuit Type	CWA
Ballast Type	Magnetic HID
Base Model	71A82J9
Core Size	4 x 4 (2 coil)
Suitable For Outdoor Use	Yes
Ignitor Catalog Number	LI501-H4
Ignitor Temperature Rating	105°C
Capacitor Value	34 MFD
Capacitor Catalog Number	7C340P24RAT1
Capacitor Requirements	240V
Capacitor Temperature Rating	105°C
Capacitor Diameter/Oval Dimensions	1.75 in
Capacitor Height	3.75 in
Automatic Restart	No
Operating and Electrical	
Input Voltage	220/240 V

Input Frequency	60 Hz
Input Current (Open Circuit)	1/0.9 A
Input Current (Starting)	0.8/0.7 A
Input Current (Short Circuit)	0.51-0.77/0.47-0.7 A
Secondary Short Circuit Current	3.7-4.5 A
Constant Wattage Deviation	Within Trapezoid
Ballast Factor (Nom)	1
Power Factor (Nom)	0.90
Open Circuit Voltage	188 V
Input Current (Nom)	1.35/1.25 A A
Input Power (Nom)	285 W
Rated Lamp Power	250 W

### Wiring

Wire Striplength	0.5 mm
Wire Length by Color	12"
Wire Type	Stranded
Remote Wiring Configuration Allowed	Yes
Max Ballast-Lamp Distance Remote Wiring	5'
Recommended Fuse Value	4/4 A

## Core & Coil (71A) HPS 200W - 400W

### Approval and Application

Open Circuit Voltage Test (Volts)	170-205 V
Approval Marks	FIDE Certificate NOM certificate RoHS Compliant
Temperature Marking	A/A
UL Recognized	No
Hipot Test (1 Minute)	2000 V
Hipot Test (2 Seconds)	2500 V
UL Insulation Class	H(180°C)
UL Temperature Code	1029A

### Product Data

Order product name	CORE & COIL HID 71A82J9500DML
EAN/UPC - Product	781087039403
Order code	913710592010
Numerator - Quantity Per Pack	1
Numerator - Packs per outer box	2
Material Nr. (12NC)	913710592010
Net Weight (Piece)	4.690 kg

### Dimensional drawing

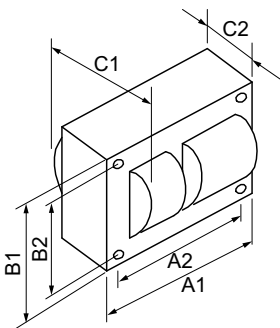

HPS BAL 250W S50 220/240V C&C

Product	C1	C2	A1	A2	B1	B2
CORE & COIL HID 71A82J9500DML	3.4 in	1.8 in	4.8 in	4.4 in	4.3 in	3.9 in

