



Core & Coil (71A) MH ~GT~ 450W

CORE & COIL HID MH BAL 1000W M47 220V C&C

The basic ballast is the open core and coil which is most often used as a component within a lighting luminaire. The core and coil also forms the nucleus of Philips Advance's five other ballast configurations.

Product data

General Information			
ANSI Code	M47	Input Frequency	60 Hz
Lamp Type	1000W MH	Input Current (Open Circuit)	2.3 A
Number of Lamps	1 piece/unit	Input Current (Starting)	4.52 A
Circuit Type	CWA	Input Current (Short Circuit)	3.64-5.47 V
Ballast Type	Magnetic HID	Secondary Short Circuit Current	4.9-6.1 A
Base Model	71A65J0	Constant Wattage Deviation	10%
Core Size	4 1/4 x 4 3/4 (2 coil)	Ballast Factor (Nom)	1
Suitable For Outdoor Use	Yes	Power Factor (Nom)	0.90
Ignitor Catalog Number	NA	Open Circuit Voltage	415 V
Ignitor Temperature Rating	NA	Input Current (Nom)	4.9 A A
Capacitor Value	24 MFD	Input Power (Nom)	1080 W
Capacitor Catalog Number	MD2409000	Rated Lamp Power	1000 W
Capacitor Requirements	480V	Wiring	
Capacitor Temperature Rating	90°C	Wire Striplength	0.5 mm
Capacitor Diameter/Oval Dimensions	1.75 in	Wire Length by Color	12"
Capacitor Height	3.9 in	Wire Type	Stranded
Automatic Restart	No	Remote Wiring Configuration Allowed	Yes
Operating and Electrical		Max Ballast-Lamp Distance Remote Wiring	Determined by AWG used
Input Voltage	220 V	Recommended Fuse Value	12 A

Core & Coil (71A) MH ~GT~ 450W

Approval and Application	
Open Circuit Voltage Test (Volts)	370-460 V
Approval Marks	NOM certificate RoHS Compliant
Temperature Marking	C
UL Recognized	No
Hipot Test (1 Minute)	2000 V
Hipot Test (2 Seconds)	2500 V
UL Insulation Class	H(180°C)
UL Temperature Code	1029C

Product Data	
Order product name	CORE & COIL HID MH BAL 1000W M47 220V C&C

EAN/UPC - Product	781087048580
Order code	913710598902
Numerator - Quantity Per Pack	1
Numerator - Packs per outer box	1
Material Nr. (12NC)	913710598902
Net Weight (Piece)	8.605 kg

Dimensional drawing

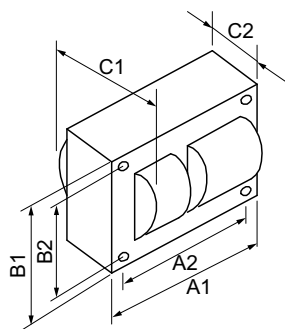

Product	C1	C2	A1	A2	B1	B2
CORE & COIL HID MH BAL 1000W M47 220V C&C	5.29 in	3.33 in	4.8 in	4.4 in	4.3 in	3.9 in

MH BAL 1000W M47 220V C&C

