



Core & Coil (71A) HPS 200W - 400W

CORE & COIL HID HPS BAL 250W S50 5-TAP C&C

The basic ballast is the open core and coil which is most often used as a component within a lighting luminaire. The core and coil also forms the nucleus of Philips Advance's five other ballast configurations.

Product data

General Information		Operating and Electrical	
ANSI Code	S50	Input Voltage	120/208/240/277/480 V
Lamp Type	250W HPS	Input Frequency	60 Hz
Number of Lamps	1 piece/unit	Input Current (Open Circuit)	1.82/1.1/0.92/0.83/0.45 A
Circuit Type	CWA	Input Current (Starting)	1.32/0.82/0.66/0.56/0.32 A
Ballast Type	Magnetic HID	Input Current (Short Circuit)	0.81-1.22/0.44-0.66/0.39-0.58/0.32-0.49/0.2-0.3 A
Base Model	71A8251A	Secondary Short Circuit Current	3.69-4.51 A
Core Size	4 x 4 (2 coil)	Constant Wattage Deviation	Within Trapezoid
Suitable For Outdoor Use	Yes	Ballast Factor (Nom)	1
Ignitor Catalog Number	LI501-H4	Power Factor (Nom)	0.90
Ignitor Temperature Rating	105°C	Open Circuit Voltage	188 V
Capacitor Value	35 MFD	Input Current (Nom)	2.66/1.54/1.32/1.16/0.66 A A
Capacitor Catalog Number	7C350P24RA	Input Power (Nom)	300 W
Capacitor Requirements	240V	Rated Lamp Power	250 W
Capacitor Temperature Rating	105°C		
Capacitor Diameter/Oval	1.65 in		
Dimensions		Wiring	
Capacitor Height	3.7 in	Wire Striplength	0.5 mm
Automatic Restart	No	Wire Length by Color	12"
		Wire Type	Stranded
		Remote Wiring Configuration	Yes
		Allowed	

Core & Coil (71A) HPS 200W - 400W

Max Ballast-Lamp Distance	2'
Remote Wiring	
Recommended Fuse Value	7/4/4/3/2 A
Approval and Application	
Open Circuit Voltage Test (Volts)	169-207 V
Approval Marks	ULR CSA certificate RoHS Compliant
Temperature Marking	C/C/B/B/B
UL Recognized	Yes
Hipot Test (1 Minute)	2000 V
Hipot Test (2 Seconds)	2500 V
UL Insulation Class	H(180°C)
UL Temperature Code	1029C

Product Data	
Order product name	CORE & COIL HID HPS BAL 250W S50 5-TAP C&C
EAN/UPC - Product	781087052303
Order code	120600
Local order code	120600
Numerator - Quantity Per Pack	1
Numerator - Packs per outer box	4
Material Nr. (12NC)	913710605202
Net Weight (Piece)	5.793 kg

Dimensional drawing

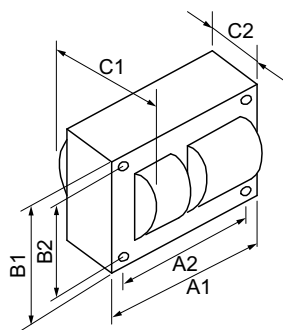

HPS BAL 250W S50 5-TAP C&C

Product	C1	C2	A1	A2	B1	B2
CORE & COIL HID 71A8251500DA	3.65 in	2 in	4.8 in	4.4 in	4.3 in	3.9 in

