



Core & Coil (71A) HPS 200W - 400W

CORE & COIL HID HPS BAL 250W S50 480V C&C

The basic ballast is the open core and coil which is most often used as a component within a lighting luminaire. The core and coil also forms the nucleus of Philips Advance's five other ballast configurations.

Product data

| General Information | | | |
|------------------------------------|----------------|---|------------------|
| ANSI Code | S50 | Input Frequency | 60 Hz |
| Lamp Type | 250W HPS | Inp. Current (Open Circuit) | 0.42 A |
| Number of Lamps | 1 piece/unit | Input Current (Starting) | 0.38 A |
| Circuit Type | CWA | Input Current (Short Circuit) | 0.26-0.39 A |
| Ballast Type | Magnetic HID | Secondary Short Circuit Current | 3.65-4.45 A |
| Base Model | 71A8241A | Constant Wattage Deviation | Within Trapezoid |
| Core Size | 4 x 4 (2 coil) | Ballast Factor (Nom) | 1 |
| Suitable For Outdoor Use | Yes | Power Factor (Nom) | 0.90 |
| Ignitor Catalog Number | LI501-H4 | Nominal Open Circuit Voltage | 189 V |
| Ignitor Temperature Rating | 105°C | Input Current (Operating) (Nom) | 0.63 A A |
| Capacitor Value | 35 MFD | Input Power (Nom) | 299 W |
| Capacitor Catalog Number | 7C350P24RA | Rated Lamp Watts | 250 W |
| Capacitor Requirements | 240V | Wiring | |
| Capacitor Temperature Rating | 105°C | Wire Striplength | 0.5 mm |
| Capacitor Diameter/Oval Dimensions | 1.65 in | Wire Length by Color | 12" |
| Capacitor Height | 3.7 in | Wire Type | Stranded |
| Automatic Restart | No | Remote Wiring Configuration Allowed | Yes |
| Operating and Electrical | | Max Ballast-Lamp Distance Remote Wiring | 2' |
| Input Voltage | 480 V | Recommended Fuse Value | 2 A |

Core & Coil (71A) HPS 200W - 400W

Approval and Application

| | |
|-----------------------------------|------------------------------------|
| Open Circuit Voltage Test (Volts) | 170-205 V |
| Approbation Marks | ULR CSA certificate RoHS Compliant |
| Temperature Marking | B |
| UL Recognized | Yes |
| Hipot Test (1 Minute) | 2000 V |
| Hipot Test (2 Seconds) | 2500 V |
| UL Insulation Class | H(180°C) |
| UL Temperature Code | 1029B |

Product Data

| | |
|--------------------|--|
| Order product name | CORE & COIL HID HPS BAL 250W S50 480V C&C |
|--------------------|--|

| | |
|---------------------------------|--------------|
| EAN/UPC - Product | 781087055632 |
| Order code | 71A8241500DA |
| Numerator - Quantity Per Pack | 1 |
| Numerator - Packs per outer box | 4 |
| Material Nr. (12NC) | 913710610502 |
| Net Weight (Piece) | 4.976 kg |

Dimensional drawing

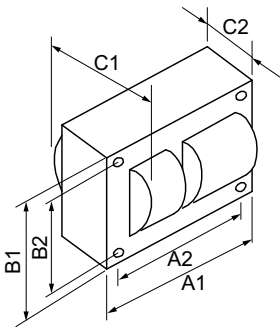

HPS BAL 250W S50 480V C&C

| Product | C1 | C2 | A1 | A2 | B1 | B2 |
|------------------------------|---------|---------|--------|--------|--------|--------|
| CORE & COIL HID 71A8241500DA | 3.72 in | 1.82 in | 4.8 in | 4.4 in | 4.3 in | 3.9 in |

