



# Core & Coil (71A) HPS 200W - 400W

## CORE & COIL HID HPS BAL 250W S50 480V C&C

The basic ballast is the open core and coil which is most often used as a component within a lighting luminaire. The core and coil also forms the nucleus of Philips Advance's five other ballast configurations.

### Product data

General Information		Electrical	
ANSI Code	S50	Input Frequency	60 Hz
Lamp Type	250W HPS	Input Current (Open Circuit)	0.42 A
Number of Lamps	1 piece/unit	Input Current (Starting)	0.38 A
Circuit Type	CWA	Input Current (Short Circuit)	0.26-0.39 A
Ballast Type	Magnetic HID	Secondary Short Circuit Current	3.65-4.45 A
Base Model	71A8241A	Constant Wattage Deviation	Within Trapezoid
Core Size	4 x 4 (2 coil)	Ballast Factor (Nom)	1
Suitable For Outdoor Use	Yes	Power Factor (Nom)	0.90
Ignitor Catalog Number	LI501-H4	Open Circuit Voltage	189 V
Ignitor Temperature Rating	105°C	Input Current (Nom)	0.63 A A
Capacitor Value	35 MFD	Input Power (Nom)	299 W
Capacitor Catalog Number	7C350P24RA	Rated Lamp Power	250 W
Capacitor Requirements	240V	Wiring	
Capacitor Temperature Rating	105°C	Wire Striplength	0.5 mm
Capacitor Diameter/Oval Dimensions	1.65 in	Wire Length by Color	12"
Capacitor Height	3.7 in	Wire Type	Stranded
Automatic Restart	No	Remote Wiring Configuration Allowed	Yes
Operating and Electrical		Max Ballast-Lamp Distance Remote Wiring 2'	
Input Voltage	480 V	Recommended Fuse Value	2 A

## Core & Coil (71A) HPS 200W - 400W

### Approval and Application

Open Circuit Voltage Test (Volts)	170-205 V
Approval Marks	ULR CSA certificate RoHS Compliant
Temperature Marking	B
UL Recognized	Yes
Hipot Test (1 Minute)	2000 V
Hipot Test (2 Seconds)	2500 V
UL Insulation Class	H(180°C)
UL Temperature Code	1029B

### Product Data

Order product name	CORE & COIL HID HPS BAL 250W S50 480V C&C
--------------------	--

EAN/UPC - Product	781087055632
Order code	913710610502
Numerator - Quantity Per Pack	1
Numerator - Packs per outer box	4
Material Nr. (12NC)	913710610502
Net Weight (Piece)	4.976 kg

### Dimensional drawing

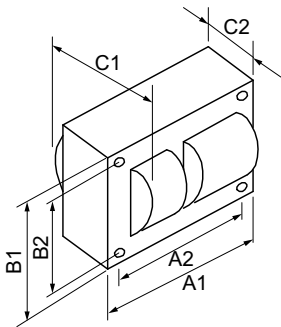

HPS BAL 250W S50 480V C&C

Product	C1	C2	A1	A2	B1	B2
CORE & COIL HID 71A8241500DA	3.72 in	1.82 in	4.8 in	4.4 in	4.3 in	3.9 in

