

# Core & Coil (71A) MH ~LT~ 175W

## CORE & COIL HID MH BAL 50W M110 QUAD C&C

The basic ballast is the open core and coil which is most often used as a component within a lighting luminaire. The core and coil also forms the nucleus of Philips Advance's five other ballast configurations.

### Product data

General Information			
ANSI Code	M110	Input Frequency	60 Hz
Lamp Type	50W MH	Input Current (Open Circuit)	1.2/0.68/0.59/0.51 A
Number of Lamps	1 piece/unit	Input Current (Starting)	0.46/0.27/0.17/0.2 A
Circuit Type	HX-HPF	Input Current (Short Circuit)	0.42-0.65/0.25-0.37/0.21-0.32/0.16-0.27 A
Ballast Type	Magnetic HID	Secondary Short Circuit Current	0.7-0.88 A
Base Model	71A5191	Constant Wattage Deviation	10%
Core Size	3 X 4 (2 coil)	Ballast Factor (Nom)	1
Suitable For Outdoor Use	Yes	Power Factor (Nom)	0.90
Ignitor Catalog Number	LI533-H4	Open Circuit Voltage	254 V
Ignitor Temperature Rating	105°C	Input Current (Nom)	0.58/0.33/0.29/0.25 A A
Capacitor Value	6 MFD	Input Power (Nom)	67 W
Capacitor Catalog Number	7C060L30RA	Rated Lamp Power	50 W
Capacitor Requirements	280V	Wiring	
Capacitor Temperature Rating	105°C	Wire Striplength	0.5 mm
Capacitor Diameter/Oval Dimensions	1.25 in	Wire Length by Color	12"
Capacitor Height	2.75 in	Wire Type	Stranded
Automatic Restart	No	Remote Wiring Configuration Allowed	Yes
Operating and Electrical		Max Ballast-Lamp Distance Remote	10'
Input Voltage	120/208/240/277 V	Wiring	

## Core & Coil (71A) MH ~LT~ 175W

Recommended Fuse Value	3/3/2/2 A
<b>Approval and Application</b>	
Open Circuit Voltage Test (Volts)	228-280 V
Approval Marks	ULR CSA certificate RoHS Compliant
Temperature Marking	A/A/A/A
UL Recognized	Yes
Hipot Test (1 Minute)	2000 V
Hipot Test (2 Seconds)	2500 V
UL Insulation Class	H(180°C)
UL Temperature Code	1029A

<b>Product Data</b>	
Order product name	CORE & COIL HID MH BAL 50W M110 QUAD C&C
EAN/UPC - Product	781087062876
Order code	913710651702
Numerator - Quantity Per Pack	1
Numerator - Packs per outer box	6
Material Nr. (12NC)	913710651702
Net Weight (Piece)	1.947 kg

### Dimensional drawing

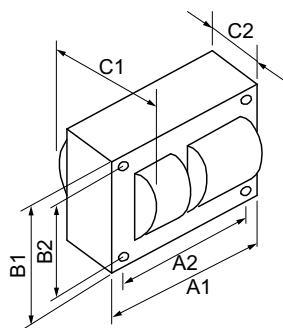

Product	C1	C2	A1	A2	B1	B2
CORE & COIL HID 71A5191500D	2.23 in	1.18 in	3.9 in	3.5 in	2.8 in	2.4 in

MH BAL 50W M110 QUAD C&C

