



Core & Coil (71A) HPS ~LT~ 200W

CORE & COIL HID HPS BAL 50W S68 QUAD C&C

The basic ballast is the open core and coil which is most often used as a component within a lighting luminaire. The core and coil also forms the nucleus of Philips Advance's five other ballast configurations.

Product data

General Information		Input Frequency	60 Hz
ANSI Code	S68	Input Current (Open Circuit)	1/0.57/0.5/0.45 A
Lamp Type	50W HPS	Input Current (Starting)	0.65/0.37/0.32/0.3 A
Number of Lamps	1 piece/unit	Input Current (Short Circuit)	0.6-0.8/0.32-0.48/0.3-0.4/0.25-0.35 A
Circuit Type	HX-HPF	Secondary Short Circuit Current	1.3-1.9 A
Ballast Type	Magnetic HID	Constant Wattage Deviation	Within Trapezoid
Base Model	71A7891	Ballast Factor (Nom)	1
Core Size	3 X 4 (2 coil)	Power Factor (Nom)	0.90
Suitable For Outdoor Use	Yes	Open Circuit Voltage	125 V
Ignitor Catalog Number	LI551-H4	Input Current (Nom)	0.61/0.35/0.31/0.26 A A
Ignitor Temperature Rating	105°C	Input Power (Nom)	66 W
Capacitor Value	5 MFD	Rated Lamp Power	50 W
Capacitor Catalog Number	7C050L30RA	Wiring	
Capacitor Requirements	300V	Wire Striplength	0.5 mm
Capacitor Temperature Rating	105°C	Wire Length by Color	12"
Capacitor Diameter/Oval Dimensions	1.25 in	Wire Type	Stranded
Capacitor Height	2.25 in	Remote Wiring Configuration Allowed	Yes
Automatic Restart	No	Max Ballast-Lamp Distance Remote	2'
Operating and Electrical		Wiring	
Input Voltage	120/208/240/277 V		

Core & Coil (71A) HPS ~LT~ 200W

Recommended Fuse Value	3/2/2/1 A
Approval and Application	
Open Circuit Voltage Test (Volts)	115-135 V
Approval Marks	ULR CSA certificate RoHS Compliant
Temperature Marking	A/A/A/A
UL Recognized	Yes
Hipot Test (1 Minute)	2000 V
Hipot Test (2 Seconds)	2500 V
UL Insulation Class	H(180°C)
UL Temperature Code	1029A

Product Data	
Order product name	CORE & COIL HID HPS BAL 50W S68 QUAD C&C
EAN/UPC - Product	781087062883
Order code	913710651802
Numerator - Quantity Per Pack	1
Numerator - Packs per outer box	6
Material Nr. (12NC)	913710651802
Net Weight (Piece)	1.801 kg

Dimensional drawing

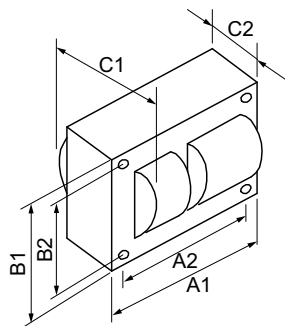

Product	C1	C2	A1	A2	B1	B2
CORE & COIL HID 71A7891500D	2.2 in	1 in	3.9 in	3.5 in	2.8 in	2.4 in

HPS BAL 50W S68 QUAD C&C

