

# Core & Coil (71A) MH ~LT~ 175W

## CORE & COIL HID MH BAL 70W M139 120/277/347V C&C

The basic ballast is the open core and coil which is most often used as a component within a lighting luminaire. The core and coil also forms the nucleus of Philips Advance's five other ballast configurations.

### Product data

General Information		Operating and Electrical	
ANSI Code	M139	Input Voltage	120/277/347 V
Lamp Type	70W MH	Input Frequency	60 Hz
Number of Lamps	1 piece/unit	Input Current (Open Circuit)	1.9/0.8/0.65 A
Circuit Type	HX-HPF	Input Current (Starting)	1.05/0.45/0.38 A
Ballast Type	Magnetic HID	Input Current (Short Circuit)	0.85-1.25/0.35-0.56/0.3-0.45 A
Base Model	71A52A1	Secondary Short Circuit Current	1.1-1.4 A
Core Size	3 X 4 (2 coil)	Constant Wattage Deviation	7%
Suitable For Outdoor Use	Yes	Ballast Factor (Nom)	1
Ignitor Catalog Number	LI533-H4	Power Factor (Nom)	0.90
Ignitor Temperature Rating	105°C	Open Circuit Voltage	255 V
Capacitor Value	8 MFD	Input Current (Nom)	0.81/0.35/0.28 A A
Capacitor Catalog Number	7C080L30RA	Input Power (Nom)	94 W
Capacitor Requirements	280V	Rated Lamp Power	70 W
Capacitor Temperature Rating	105°C		
Capacitor Diameter/Oval Dimensions	1.25 in	Wiring	
Capacitor Height	2.75 in	Wire Striplength	0.5 mm
Automatic Restart	No	Wire Length by Color	12"
		Wire Type	Stranded
		Remote Wiring Configuration Allowed	Yes

## Core & Coil (71A) MH ~LT~ 175W

Max Ballast-Lamp Distance Remote	5'
Wiring	
Recommended Fuse Value	4/2/2 A

### Approval and Application

Open Circuit Voltage Test (Volts)	230-280 V
Approval Marks	ULR CSA certificate RoHS Compliant
Temperature Marking	A/A/A
UL Recognized	Yes
Hipot Test (1 Minute)	1500 V
Hipot Test (2 Seconds)	2500 V
UL Insulation Class	H(180°C)
UL Temperature Code	1029A

### Product Data

Order product name	CORE & COIL HID MH BAL 70W M139 120/277/347V C&C
EAN/UPC - Product	781087066584
Order code	913710655502
Numerator - Quantity Per Pack	1
Numerator - Packs per outer box	6
Material Nr. (12NC)	913710655502
Net Weight (Piece)	2.355 kg

### Dimensional drawing

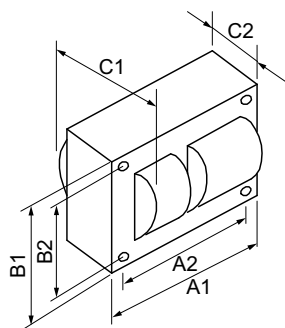

MH BAL 70W M139 120/277/347V C&C

Product	C1	C2	A1	A2	B1	B2
CORE & COIL HID 71A52A1510D	2.80 in	1.5 in	3.9 in	3.5 in	2.8 in	2.4 in

