

**PHILIPS**

# Lighting

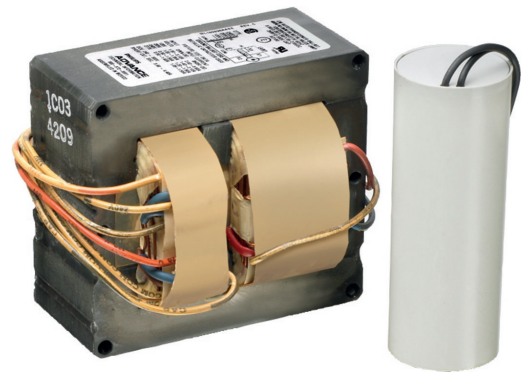

## Core & Coil (71A) HPS ~LT~ 200W

**CORE & COIL HID HPS BAL 150W S55 127/220W  
C&C**

The basic ballast is the open core and coil which is most often used as a component within a lighting luminaire. The core and coil also forms the nucleus of Philips Advance's five other ballast configurations.

## Product data

General Information	
ANSI Code	S55
Lamp Type	150W HPS
Number of Lamps	1 piece/unit
Circuit Type	CWA
Ballast Type	Magnetic HID
Base Model	71A81H8A
Core Size	3 X 4 (2 LW)
Suitable For Outdoor Use	Yes
Ignitor Catalog Number	LI551-J4
Ignitor Temperature Rating	105°C
Capacitor Value	55 MFD
Capacitor Catalog Number	7C550P24RA
Capacitor Requirements	170V
Capacitor Temperature Rating	105°C
Capacitor Diameter/Oval Dimensions	1.85 in
Capacitor Height	3.7 in
Automatic Restart	No

Operating and Electrical	
Input Voltage	127/220 V
Input Frequency	60 Hz
Inp. Current (Open Circuit)	0.97/0.56 A
Input Current (Starting)	1.11/0.68 A
Input Current (Short Circuit)	0.7-1.05/0.4-0.61 A
Secondary Short Circuit Current	3.97-4.86 A
Constant Wattage Deviation	Within Trapezoid
Ballast Factor (Nom)	1
Power Factor (Nom)	0.90
Nominal Open Circuit Voltage	110 V
Input Current (Operating) (Nom)	1.55/0.89 A A
Input Power (Nom)	198 W
Rated Lamp Watts	150 W
Wiring	
Wire Striplength	0.5 mm
Wire Length by Color	12"
Wire Type	Stranded
Remote Wiring Configuration Allowed	Yes

## Core & Coil (71A) HPS ~LT~ 200W

Max Ballast-Lamp Distance Remote Wiring	10'
Recommended Fuse Value	5/3 A
<b>Approval and Application</b>	
Open Circuit Voltage Test (Volts)	100-120 V
Approbation Marks	ULR NOM certificate RoHS Compliant
Temperature Marking	D/C
UL Recognized	Yes
Hipot Test (1 Minute)	2000 V
Hipot Test (2 Seconds)	2500 V
UL Insulation Class	H(180°C)
UL Temperature Code	1029D

### Product Data

Order product name	CORE & COIL HID HPS BAL 150W S55 127/220W C&C
EAN/UPC - Product	781087074886
Order code	71A81H8500DMLA
Numerator - Quantity Per Pack	1
Numerator - Packs per outer box	2
Material Nr. (12NC)	913710655709
Net Weight (Piece)	4.400 kg

### Dimensional drawing

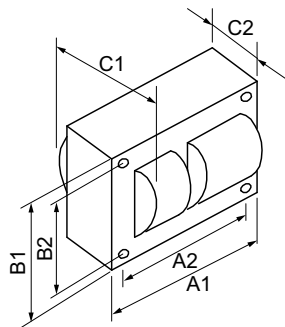

HPS BAL 150W S55 127/220W C&C

Product	C1	C2	A1	A2	B1	B2
CORE & COIL HID HPS BAL 150W S55 127/220W C&C	4.54 in	3.04 in	3.9 in	3.5 in	2.8 in	2.4 in

