



Lighting



Core & Coil (71A) HPS ~LT~ 200W

**CORE & COIL HID HPS BAL 150W S55 127/220W
C&C**

The basic ballast is the open core and coil which is most often used as a component within a lighting luminaire. The core and coil also forms the nucleus of Philips Advance's five other ballast configurations.

Product data

| General Information | |
|------------------------------------|--------------|
| ANSI Code | S55 |
| Lamp Type | 150W HPS |
| Number of Lamps | 1 piece/unit |
| Circuit Type | CWA |
| Ballast Type | Magnetic HID |
| Base Model | 71A81H8A |
| Core Size | 3 X 4 (2 LW) |
| Suitable For Outdoor Use | Yes |
| Ignitor Catalog Number | LI551-J4 |
| Ignitor Temperature Rating | 105°C |
| Capacitor Value | 55 MFD |
| Capacitor Catalog Number | 7C550P24RA |
| Capacitor Requirements | 170V |
| Capacitor Temperature Rating | 105°C |
| Capacitor Diameter/Oval Dimensions | 1.85 in |
| Capacitor Height | 3.7 in |
| Automatic Restart | No |

| Operating and Electrical | |
|-------------------------------------|---------------------|
| Input Voltage | 127/220 V |
| Input Frequency | 60 Hz |
| Input Current (Open Circuit) | 0.97/0.56 A |
| Input Current (Starting) | 1.11/0.68 A |
| Input Current (Short Circuit) | 0.7-1.05/0.4-0.61 A |
| Secondary Short Circuit Current | 3.97-4.86 A |
| Constant Wattage Deviation | Within Trapezoid |
| Ballast Factor (Nom) | 1 |
| Power Factor (Nom) | 0.90 |
| Open Circuit Voltage | 110 V |
| Input Current (Nom) | 1.55/0.89 A A |
| Input Power (Nom) | 198 W |
| Rated Lamp Power | 150 W |
| | |
| Wiring | |
| Wire Striplength | 0.5 mm |
| Wire Length by Color | 12" |
| Wire Type | Stranded |
| Remote Wiring Configuration Allowed | Yes |

Core & Coil (71A) HPS ~LT~ 200W

| | |
|---|------------------------------------|
| Max Ballast-Lamp Distance Remote Wiring | 10' |
| Recommended Fuse Value | 5/3 A |
| Approval and Application | |
| Open Circuit Voltage Test (Volts) | 100-120 V |
| Approval Marks | ULR NOM certificate RoHS Compliant |
| Temperature Marking | D/C |
| UL Recognized | Yes |
| Hipot Test (1 Minute) | 2000 V |
| Hipot Test (2 Seconds) | 2500 V |
| UL Insulation Class | H(180°C) |
| UL Temperature Code | 1029D |

Product Data

| | |
|---------------------------------|--|
| Order product name | CORE & COIL HID HPS BAL 150W S55 127/220W C&C |
| EAN/UPC - Product | 781087074886 |
| Order code | 913710655709 |
| Numerator - Quantity Per Pack | 1 |
| Numerator - Packs per outer box | 2 |
| Material Nr. (12NC) | 913710655709 |
| Net Weight (Piece) | 4.400 kg |

Dimensional drawing

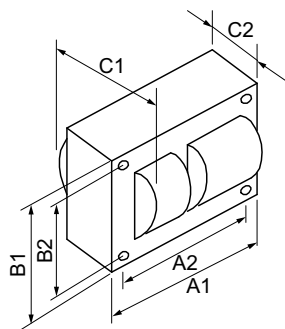

HPS BAL 150W S55 127/220W C&C

| Product | C1 | C2 | A1 | A2 | B1 | B2 |
|--|---------|---------|--------|--------|--------|--------|
| CORE & COIL HID HPS BAL 150W S55 127/220W C&C | 4.54 in | 3.04 in | 3.9 in | 3.5 in | 2.8 in | 2.4 in |

