



# Core & Coil (71A) HPS 200W - 400W

The basic ballast is the open core and coil which is most often used as a component within a lighting luminaire. The core and coil also forms the nucleus of Philips Advance's five other ballast configurations.

## Product data

General Information			
ANSI Code	S51-M169	Input current (short circuit)	0.5-0.8 A
Lamp type	400W HPS	Secondary short-circuit current	6-7.4 A
Number of lamps	1 piece/unit	Constant wattage deviation	Within Trapezoid
Circuit type	CWA	Ballast factor (nom.)	1
Ballast type	Magnetic HID	Power factor (nom.)	0.90
Base model	71A8443TA	Open circuit voltage	190 V
Core size	4 x 4 (2 coil)	Input current (nom.)	0.97 A A
Suitable for outdoor use	Yes	Input power (nom.)	464 W
Ignitor catalogue number	LI501-H4	Rated lamp power	400 W
Ignitor temperature rating	105°C		
Capacitor value	55 MFD	Wiring	
Capacitor catalogue number	7C550P24RA	Wire strip length	0.5 mm
Capacitor requirements	240V	Wire length by colour	12"
Capacitor temperature rating	105°C	Wire type	Stranded
Capacitor diameter/oval dimensions	1.85 in	Remote wiring configuration allowed	Yes
Capacitor height	3.7 in	Max. ballast-lamp distance remote wiring	2'
Automatic restart	No	Recommended fuse value	3 A
Operating and Electrical			
Input voltage	480/120T V	Approval and Application	
Input frequency	60 Hz	Open circuit voltage test (volts)	170-210 V
Input current (open circuit)	0.55 A	Approval marks	ULR CSA certificate RoHS Compliant
Input current (starting)	0.75 A	Temperature marking	D
		UL recognised	Yes
		Hipot test (1 minute)	2000 V

Core & Coil (71A) HPS 200W - 400W

Hipot test (2 seconds)	2500 V
UL insulation class	H(180°C)
UL temperature code	1029D

Product Data

Order product name	CORE & COIL HID 71A8443500DTA
EAN/UPC – product	781087067000

Numerator – quantity per pack	1
Numerator – packs per outer box	4
Material no. (12NC)	913710656202
Net weight (piece)	6.900 kg

Dimensional drawing

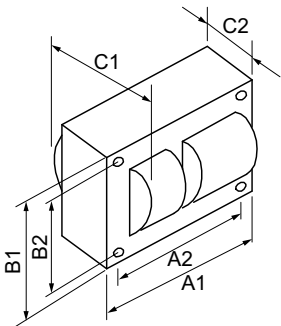

HPS BAL 400W S51 480V/120T C&C

Product	C1	C2	A1	A2	B1	B2
CORE & COIL HID 71A8443500DTA	4.3 in	2.8 in	4.8 in	4.4 in	4.3 in	3.9 in

