

# Core & Coil (71A) HPS 200W - 400W

## CORE & COIL HID 71A8443500DTA

The basic ballast is the open core and coil which is most often used as a component within a lighting luminaire. The core and coil also forms the nucleus of Philips Advance's five other ballast configurations.

### Product data

General Information			
ANSI Code	S51-M169	Input Frequency	60 Hz
Lamp Type	400W HPS	Input Current (Open Circuit)	0.55 A
Number of Lamps	1 piece/unit	Input Current (Starting)	0.75 A
Circuit Type	CWA	Input Current (Short Circuit)	0.5-0.8 A
Ballast Type	Magnetic HID	Secondary Short Circuit Current	6-7.4 A
Base Model	71A8443TA	Constant Wattage Deviation	Within Trapezoid
Core Size	4 x 4 (2 coil)	Ballast Factor (Nom)	1
Suitable For Outdoor Use	Yes	Power Factor (Nom)	0.90
Ignitor Catalog Number	LI501-H4	Open Circuit Voltage	190 V
Ignitor Temperature Rating	105°C	Input Current (Nom)	0.97 A A
Capacitor Value	55 MFD	Input Power (Nom)	464 W
Capacitor Catalog Number	7C550P24RA	Rated Lamp Power	400 W
Capacitor Requirements	240V	Wiring	
Capacitor Temperature Rating	105°C	Wire Striplength	0.5 mm
Capacitor Diameter/Oval Dimensions	1.85 in	Wire Length by Color	12"
Capacitor Height	3.7 in	Wire Type	Stranded
Automatic Restart	No	Remote Wiring Configuration Allowed	Yes
Operating and Electrical		Max Ballast-Lamp Distance Remote Wiring	2'
Input Voltage	480/120T V	Recommended Fuse Value	3 A

## Core & Coil (71A) HPS 200W - 400W

### Approval and Application

Open Circuit Voltage Test (Volts)	170-210 V
Approval Marks	ULR CSA certificate RoHS Compliant
Temperature Marking	D
UL Recognized	Yes
Hipot Test (1 Minute)	2000 V
Hipot Test (2 Seconds)	2500 V
UL Insulation Class	H(180°C)
UL Temperature Code	1029D

### Product Data

Order product name	CORE & COIL HID 71A8443500DTA
EAN/UPC - Product	781087067000
Order code	913710656202
Numerator - Quantity Per Pack	1
Numerator - Packs per outer box	4
Material Nr. (12NC)	913710656202
Net Weight (Piece)	6.900 kg

### Dimensional drawing

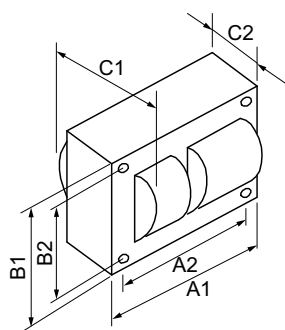

HPS BAL 400W S51 480V/120T C&C

Product	C1	C2	A1	A2	B1	B2
CORE & COIL HID 71A8443500DTA	4.3 in	2.8 in	4.8 in	4.4 in	4.3 in	3.9 in

