



Core & Coil (71A) HPS 200W - 400W

CORE & COIL HID HPS BAL 250W S50 QUAD C&C

The basic ballast is the open core and coil which is most often used as a component within a lighting luminaire. The core and coil also forms the nucleus of Philips Advance's five other ballast configurations.

Product data

General Information		Operating and Electrical	
ANSI Code	S50	Input Voltage	120/208/240/277 V
Lamp Type	250W HPS	Input Frequency	60 Hz
Number of Lamps	1 piece/unit	Inp. Current (Open Circuit)	1.53/0.95/0.77/0.63 A
Circuit Type	CWA	Input Current (Starting)	1.61/0.89/0.8/0.68 A
Ballast Type	Magnetic HID	Input Current (Short Circuit)	1.16-1.74/0.64-0.96/0.56-0.85/0.49-0.74 A
Base Model	71A8291A	Secondary Short Circuit Current	3.65-4.45 A
Core Size	4 x 4 (2 coil)	Constant Wattage Deviation	Within Trapezoid
Suitable For Outdoor Use	Yes	Ballast Factor (Nom)	1
Ignitor Catalog Number	LI501-H4	Power Factor (Nom)	0.90
Ignitor Temperature Rating	105°C	Nominal Open Circuit Voltage	187 V
Capacitor Value	35 MFD	Input Current (Operating) (Nom)	2.5/1.47/1.25/1.09 A A
Capacitor Catalog Number	7C350P24RA	Input Power (Nom)	295 W
Capacitor Requirements	240V	Rated Lamp Watts	250 W
Capacitor Temperature Rating	105°C	Wiring	
Capacitor Diameter/Oval	1.65 in	Wire Striplength	0.5 mm
Dimensions		Wire Length by Color	12"
Capacitor Height	3.7 in	Wire Type	Stranded
Automatic Restart	No	Remote Wiring Configuration	Yes
		Allowed	

Core & Coil (71A) HPS 200W - 400W

Max Ballast-Lamp Distance	2'
Remote Wiring	
Recommended Fuse Value	7/4/4/3 A
Approval and Application	
Open Circuit Voltage Test (Volts)	170-205 V
Approbation Marks	ULR CSA certificate NOM certificate RoHS Compliant
Temperature Marking	B/B/B/B
UL Recognized	Yes
Hipot Test (1 Minute)	2000 V
Hipot Test (2 Seconds)	2500 V
UL Insulation Class	H(180°C)

UL Temperature Code	1029B
Product Data	
Order product name	CORE & COIL HID HPS BAL 250W S50 QUAD C&C
EAN/UPC - Product	781087125038
Order code	71A8291520DMLA
Numerator - Quantity Per Pack	1
Numerator - Packs per outer box	2
Material Nr. (12NC)	913710658012
Net Weight (Piece)	5.158 kg

Dimensional drawing

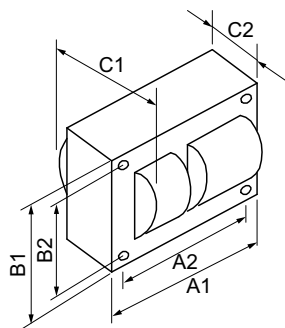

Product	C1	C2	A1	A2	B1	B2
CORE & COIL HID 71A8291520DMLA	3.82 in	1.8 in	4.8 in	4.4 in	4.3 in	3.9 in

HPS BAL 250W S50 QUAD C&C

