



# Core & Coil (71A) MH 175W - 450W

## CORE & COIL HID MH BAL 250W M58/H37 QUAD C&C

The basic ballast is the open core and coil which is most often used as a component within a lighting luminaire. The core and coil also forms the nucleus of Philips Advance's five other ballast configurations.

### Product data

General Information	
Lamp Type	250W MH
Number of Lamps	1 piece/unit
Capacitor Value	15 MFD
Operating and Electrical	
Input Voltage	120/208/240/277 V
Input Frequency	60 Hz
Power Factor (Nom)	0.90

Product Data	
Order product name	CORE & COIL HID MH BAL 250W M58/H37 QUAD C&C
EAN/UPC - Product	781087069479
Order code	71A5790500DMLA
Numerator - Quantity Per Pack	1
Numerator - Packs per outer box	2
Material Nr. (12NC)	913710663902
Net Weight (Piece)	3.888 kg

Core & Coil (71A) MH 175W - 450W

Dimensional drawing

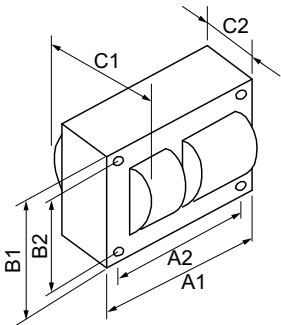

MH BAL 250W M58/H37 QUAD C&C

Product	A1	B1	C1	A2
CORE & COIL HID MH BAL 250W M58/H37 QUAD C&C	165.1 mm	88.9 mm	111.76 mm	146.05 mm

