



Core & Coil (71A) MH 175W - 450W

CORE & COIL HID MH BAL 175W M137/M152 QUAD C&C

The basic ballast is the open core and coil which is most often used as a component within a lighting luminaire. The core and coil also forms the nucleus of Philips Advance's five other ballast configurations.

Product data

General Information		Operating and Electrical	
ANSI Code	M137-M152	Input Voltage	120/208/240/277 V
Lamp Type	175W MH	Input Frequency	60 Hz
Number of Lamps	1 piece/unit	Inp. Current (Open Circuit)	1.3/0.72/0.65/0.57 A
Circuit Type	SUPER-CWA	Input Current (Starting)	0.83/0.51/0.44/0.37 A
Ballast Type	Magnetic HID	Input Current (Short Circuit)	0.66-1/0.41-0.61/0.35-0.53/0.3-0.44 A
Base Model	71A5591EE	Secondary Short Circuit Current	1.56-1.91 A
Core Size	4 1/4 x 4 3/4 (2 coil)	Constant Wattage Deviation	10%
Suitable For Outdoor Use	Yes	Ballast Factor (Nom)	1
Ignitor Catalog Number	LI533-H4	Power Factor (Nom)	0.90
Ignitor Temperature Rating	105°C	Nominal Open Circuit Voltage	285 V
Capacitor Value	11 MFD	Input Current (Operating) (Nom)	1.66/0.95/0.83/0.71 A A
Capacitor Catalog Number	7C110M40	Input Power (Nom)	198 W
Capacitor Requirements	370V	Rated Lamp Watts	175 W
Capacitor Temperature Rating	105°C	Wiring	
Capacitor Diameter/Oval	1.65 in	Wire Striplength	0.5 mm
Dimensions		Wire Length by Color	12"
Capacitor Height	3.75 in	Wire Type	Stranded
Automatic Restart	No		

Core & Coil (71A) MH 175W - 450W

Remote Wiring Configuration	Yes
Allowed	
Max Ballast-Lamp Distance	2'
Remote Wiring	
Recommended Fuse Value	5/3/3/3 A

Approval and Application

Open Circuit Voltage Test (Volts)	254-310 V
Approbation Marks	ULR CSA certificate RoHS Compliant
Temperature Marking	A/A/A/A
UL Recognized	Yes
Hipot Test (1 Minute)	2000 V
Hipot Test (2 Seconds)	2500 V
UL Insulation Class	H(180°C)

UL Temperature Code	1029A
---------------------	-------

Product Data

Order product name	CORE & COIL HID MH BAL 175W M137/M152 QUAD C&C
EAN/UPC - Product	781087070260
Order code	71A5591500DEE
Numerator - Quantity Per Pack	1
Numerator - Packs per outer box	4
Material Nr. (12NC)	913710664902
Net Weight (Piece)	4.750 kg

Dimensional drawing

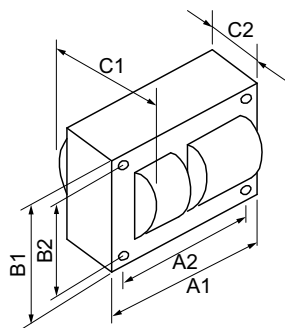

MH BAL 175W M137/M152 QUAD C&C

Product	C1	C2	A1	A2	B1	B2
CORE & COIL HID 71A5591500DEE	3.30 in	1.65 in	4.8 in	4.4 in	4.3 in	3.9 in

