



Core & Coil (71A) MH 175W - 450W

CORE & COIL HID MH BAL 200W M136 QUAD C&C

The basic ballast is the open core and coil which is most often used as a component within a lighting luminaire. The core and coil also forms the nucleus of Philips Advance's five other ballast configurations.

Product data

General Information	
ANSI Code	M136
Lamp Type	200W MH
Number of Lamps	1 piece/unit
Circuit Type	SUPER-CWA
Ballast Type	Magnetic HID
Base Model	71A5692EE
Core Size	3 X 4 (2 coil)
Suitable For Outdoor Use	Yes
Ignitor Catalog Number	LI533-H4
Ignitor Temperature Rating	105°C
Capacitor Value	15 MFD
Capacitor Catalog Number	7C150M33
Capacitor Requirements	330V
Capacitor Temperature Rating	105°C
Capacitor Diameter/Oval	1.65 in
Dimensions	
Capacitor Height	3.75 in
Automatic Restart	No

Operating and Electrical	
Input Voltage	120/208/240/277 V
Input Frequency	60 Hz
Inp. Current (Open Circuit)	1.85/1.06/0.91/0.8 A
Input Current (Starting)	0.82/0.47/0.4/0.35 A
Input Current (Short Circuit)	0.47-0.71/0.28-0.42/0.24-0.36/0.21-0.31 A
Secondary Short Circuit Current	1.95-2.4 A
Constant Wattage Deviation	10%
Ballast Factor (Nom)	1
Power Factor (Nom)	0.90
Nominal Open Circuit Voltage	240 V
Input Current (Operating) (Nom)	2.12/1.22/1.06/0.93 A A
Input Power (Nom)	227 W
Rated Lamp Watts	200 W
Wiring	
Wire Striplength	0.5 mm
Wire Length by Color	12"
Wire Type	Stranded
Remote Wiring Configuration Allowed	Yes

Core & Coil (71A) MH 175W - 450W

Max Ballast-Lamp Distance Remote	2'
Wiring	
Recommended Fuse Value	6/4/3/3 A
Approval and Application	
Open Circuit Voltage Test (Volts)	225-265 V
Approbation Marks	ULR CSA certificate EISA RoHS Compliant
Temperature Marking	A/A/A/A
UL Recognized	Yes
Hipot Test (1 Minute)	2000 V
Hipot Test (2 Seconds)	2500 V
UL Insulation Class	H(180°C)

UL Temperature Code	1029A
Product Data	
Order product name	CORE & COIL HID MH BAL 200W M136 QUAD C&C
EAN/UPC - Product	781087070314
Order code	71A5692500DEE
Numerator - Quantity Per Pack	1
Numerator - Packs per outer box	4
Material Nr. (12NC)	913710665202
Net Weight (Piece)	4.296 kg

Dimensional drawing

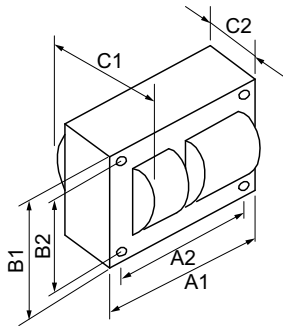

MH BAL 200W M136 QUAD C&C

Product	C1	C2	A1	A2	B1	B2
CORE & COIL HID 71A5692500DEE	4.20 in	2.95 in	3.9 in	3.5 in	2.8 in	2.4 in

