



# Core & Coil (71A) MH 175W – 450W

## CORE & COIL HID MH BAL 250W M138/M153 QUAD C&C

The basic ballast is the open core and coil which is most often used as a component within a lighting luminaire. The core and coil also forms the nucleus of Philips Advance's five other ballast configurations.

### Product data

| General Information          |                        |
|------------------------------|------------------------|
| ANSI Code                    | M138-M153              |
| Lamp Type                    | 250W MH                |
| Number of Lamps              | 1 piece/unit           |
| Circuit Type                 | SUPER-CWA              |
| Ballast Type                 | Magnetic HID           |
| Base Model                   | 71A5792EE              |
| Core Size                    | 4 1/4 x 4 3/4 (2 coil) |
| Suitable For Outdoor Use     | Yes                    |
| Ignitor Catalog Number       | LI533-H4               |
| Ignitor Temperature Rating   | 105°C                  |
| Capacitor Value              | 17 MFD                 |
| Capacitor Catalog Number     | 7C170P40               |
| Capacitor Requirements       | 330V                   |
| Capacitor Temperature Rating | 105°C                  |
| Capacitor Diameter/Oval      | 1.75 in                |
| Dimensions                   |                        |
| Capacitor Height             | 3.75 in                |
| Automatic Restart            | No                     |

| Operating and Electrical        |   |
|---------------------------------|---|
| Input Voltage                   | 120/208/240/277 V                         |
| Input Frequency                 | 60 Hz                                     |
| Inp. Current (Open Circuit)     | 1.1/0.64/0.55/0.48 A                      |
| Input Current (Starting)        | 2.27/1.34/1.13/0.98 A                     |
| Input Current (Short Circuit)   | 1.79-2.68/1.03-1.59/0.89-1.34/0.77-1.16 A |
| Secondary Short Circuit Current | 2.42-2.96 A                               |
| Constant Wattage Deviation      | 10%                                       |
| Ballast Factor (Nom)            | 1   |
| Power Factor (Nom)              | 0.90                                      |
| Nominal Open Circuit Voltage    | 280 V                                     |
| Input Current (Operating) (Nom) | 2.52/1.44/1.26/1.1 A A                    |
| Input Power (Nom)               | 291 W                                     |
| Rated Lamp Watts                | 250 W                                     |

| Wiring               |          |
|----------------------|----------|
| Wire Striplength     | 0.5 mm   |
| Wire Length by Color | 12"      |
| Wire Type            | Stranded |

## Core & Coil (71A) MH 175W - 450W

|                             |           |
|-----------------------------|-----------|
| Remote Wiring Configuration | Yes       |
| Allowed                     |           |
| Max Ballast-Lamp Distance   | 2'        |
| Remote Wiring               |           |
| Recommended Fuse Value      | 8/5/5/3 A |

### Approval and Application

|                                   |   |
|-----------------------------------|---|
| Open Circuit Voltage Test (Volts) | 254-308 V                               |
| Approbation Marks                 | ULR CSA certificate EISA RoHS Compliant |
| Temperature Marking               | A/A/A/A                                 |
| UL Recognized                     | Yes                                     |
| Hipot Test (1 Minute)             | 1500 V                                  |
| Hipot Test (2 Seconds)            | 2500 V                                  |
| UL Insulation Class               | H(180°C)                                |

|                     |       |
|---------------------|-------|
| UL Temperature Code | 1029A |
|---------------------|-------|

### Product Data

|                                 |  |
|---------------------------------|--|
| Order product name              | CORE & COIL HID MH BAL 250W M138/M153 QUAD C&C |
| EAN/UPC - Product               | 781087073292                                   |
| Order code                      | 71A5792500DEE                                  |
| Numerator - Quantity Per Pack   | 1  |
| Numerator - Packs per outer box | 4  |
| Material Nr. (12NC)             | 913710665502                                   |
| Net Weight (Piece)              | 4.967 kg                                       |

### Dimensional drawing

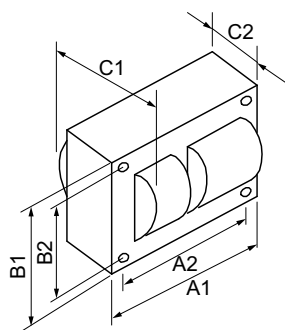

MH BAL 250W M138/M153 QUAD C&C

| Product                       | C1      | C2      | A1     | A2     | B1     | B2     |
|-------------------------------|---------|---------|--------|--------|--------|--------|
| CORE & COIL HID 71A5792500DEE | 3.55 in | 1.61 in | 4.8 in | 4.4 in | 4.3 in | 3.9 in |

