



# Core & Coil (71A) MH

## 175W - 450W

**CORE & COIL HID MH BAL 250W M138/M153  
QUAD C&C**

The basic ballast is the open core and coil which is most often used as a component within a lighting luminaire. The core and coil also forms the nucleus of Philips Advance's five other ballast configurations.

## Product data

General Information	
ANSI Code	M138-M153
Lamp Type	250W MH
Number of Lamps	1 piece/unit
Circuit Type	SUPER-CWA
Ballast Type	Magnetic HID
Base Model	71A5792EE
Core Size	4 1/4 x 4 3/4 (2 coil)
Suitable For Outdoor Use	Yes
Ignitor Catalog Number	LI533-H4
Ignitor Temperature Rating	105°C
Capacitor Value	17 MFD
Capacitor Catalog Number	7C170P40
Capacitor Requirements	330V
Capacitor Temperature Rating	105°C
Capacitor Diameter/Oval Dimensions	1.75 in
Capacitor Height	3.75 in
Automatic Restart	No

Operating and Electrical	
Input Voltage	120/208/240/277 V
Input Frequency	60 Hz
Input Current (Open Circuit)	1.1/0.64/0.55/0.48 A
Input Current (Starting)	2.27/1.34/1.13/0.98 A
Input Current (Short Circuit)	1.79-2.68/1.03-1.59/0.89-1.34/0.77-1.16 A
Secondary Short Circuit Current	2.42-2.96 A
Constant Wattage Deviation	10%
Ballast Factor (Nom)	1
Power Factor (Nom)	0.90
Open Circuit Voltage	280 V
Input Current (Nom)	2.52/1.44/1.26/1.1 A A
Input Power (Nom)	291 W
Rated Lamp Power	250 W
Wiring	
Wire Striplength	0.5 mm
Wire Length by Color	12"
Wire Type	Stranded

## Core & Coil (71A) MH 175W - 450W

Remote Wiring Configuration	Yes
Allowed	
Max Ballast-Lamp Distance	2'
Remote Wiring	
Recommended Fuse Value	8/5/5/3 A

### Approval and Application

Open Circuit Voltage Test (Volts)	254-308 V
Approval Marks	ULR CSA certificate EISA RoHS Compliant
Temperature Marking	A/A/A/A
UL Recognized	Yes
Hipot Test (1 Minute)	1500 V
Hipot Test (2 Seconds)	2500 V
UL Insulation Class	H(180°C)

UL Temperature Code	1029A
---------------------	-------

### Product Data

Order product name	CORE & COIL HID MH BAL 250W M138/M153 QUAD C&C
EAN/UPC - Product	781087073292
Order code	913710665502
Numerator - Quantity Per Pack	1
Numerator - Packs per outer box	4
Material Nr. (12NC)	913710665502
Net Weight (Piece)	4.967 kg

### Dimensional drawing

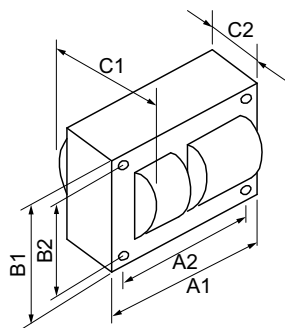

MH BAL 250W M138/M153 QUAD C&C

Product	C1	C2	A1	A2	B1	B2
CORE & COIL HID 71A5792500DEE	3.55 in	1.61 in	4.8 in	4.4 in	4.3 in	3.9 in

