



Core & Coil (71A) MH

**CORE & COIL HID MH BAL 320W M132/M154
QUAD C&C**

The basic ballast is the open core and coil which is most often used as a component within a lighting luminaire. The core and coil also forms the nucleus of Philips Advance's five other ballast configurations.

Product data

General Information	
ANSI Code	M132-M154
Lamp Type	320W MH
Number of Lamps	1 piece/unit
Circuit Type	SUPER-CWA
Ballast Type	Magnetic HID
Base Model	71A5892AEE
Core Size	4 1/4 x 4 3/4 (2 coil)
Suitable For Outdoor Use	Yes
Ignitor Catalog Number	LI533-H4
Ignitor Temperature Rating	105°C
Capacitor Value	21 MFD
Capacitor Catalog Number	7C210P40R
Capacitor Requirements	400V
Capacitor Temperature Rating	105°C
Capacitor Diameter/Oval Dimensions	1.75 in
Capacitor Height	4.80 in
Automatic Restart	No

Operating and Electrical

Input Voltage	120/208/240/277 V
Input Frequency	60 Hz
Inp. Current (Open Circuit)	1.46/0.79/0.74/0.62 A
Input Current (Starting)	2.7/1.52/1.35/1.16 A
Input Current (Short Circuit)	2.16-3.24/1.21-1.82/1.08-1.62/0.93-1.39 A
Secondary Short Circuit Current	2.9-3.6 A
Constant Wattage Deviation	10%
Ballast Factor (Nom)	1
Power Factor (Nom)	0.90
Nominal Open Circuit Voltage	280 V
Input Current (Operating) (Nom)	3.25/1.9/1.65/1.4 A A
Input Power (Nom)	368 W
Rated Lamp Watts	320 W

Wiring

Wire Striplength	0.5 mm
Wire Length by Color	12"
Wire Type	Stranded
Remote Wiring Configuration Allowed	Yes

Core & Coil (71A) MH 175W - 450W

Max Ballast-Lamp Distance Remote Wiring	2'
Recommended Fuse Value	8/6/5/3 A

Approval and Application

Open Circuit Voltage Test (Volts)	254-310 V
Approbation Marks	ULR CSA certificate EISA RoHS Compliant
Temperature Marking	A/A/A/A
UL Recognized	Yes
Hipot Test (1 Minute)	2000 V
Hipot Test (2 Seconds)	2500 V
UL Insulation Class	H(180°C)
UL Temperature Code	1029A

Product Data

Order product name	CORE & COIL HID 71A5892500DAEE
EAN/UPC - Product	781087070390
Order code	71A5892500DAEE
Numerator - Quantity Per Pack	1
Numerator - Packs per outer box	4
Material Nr. (12NC)	913710665802
Net Weight (Piece)	5.303 kg

Dimensional drawing

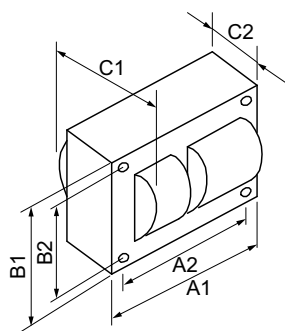

MH BAL 320W M132/M154 QUAD C&C

Product	C1	C2	A1	A2	B1	B2
CORE & COIL HID 71A5892500DAEE	3.77 in	2.06 in	4.8 in	4.4 in	4.3 in	3.9 in

