



Core & Coil (71A) MH 175W – 450W

CORE & COIL HID MH BAL 350W M131 QUAD C&C

The basic ballast is the open core and coil which is most often used as a component within a lighting luminaire. The core and coil also forms the nucleus of Philips Advance's five other ballast configurations.

Product data

| General Information | |
|------------------------------------|------------------------|
| ANSI Code | M131-M171 |
| Lamp Type | 350W MH |
| Number of Lamps | 1 piece/unit |
| Circuit Type | SUPER-CWA |
| Ballast Type | Magnetic HID |
| Base Model | 71A5993AEE |
| Core Size | 4 1/4 x 4 3/4 (2 coil) |
| Suitable For Outdoor Use | Yes |
| Ignitor Catalog Number | LI533-H4 |
| Ignitor Temperature Rating | 105°C |
| Capacitor Value | 22.5 MFD |
| Capacitor Catalog Number | 7C225P40 |
| Capacitor Requirements | 345V |
| Capacitor Temperature Rating | 105°C |
| Capacitor Diameter/Oval Dimensions | 1.75 in |
| Capacitor Height | 4.80 in |
| Automatic Restart | No |

| Operating and Electrical | |
|--------------------------|-------------------|
| Input Voltage | 120/208/240/277 V |

| | |
|---------------------------------|---|
| Input Frequency | 60 Hz |
| Inp. Current (Open Circuit) | 2.2/1.27/1.12/1 A |
| Input Current (Starting) | 2.55/1.45/1.27/1.1 A |
| Input Current (Short Circuit) | 2.04-3.06/1.16-1.75/1.01-1.52/0.88-1.32 A |
| Secondary Short Circuit Current | 3.25-4 A |
| Constant Wattage Deviation | 10% |
| Ballast Factor (Nom) | 1 |
| Power Factor (Nom) | 0.90 |
| Nominal Open Circuit Voltage | 280 V |
| Input Current (Operating) (Nom) | 3.4/2/1.7/1.5 A A |
| Input Power (Nom) | 397 W |
| Rated Lamp Watts | 350 W |

| Wiring | |
|-------------------------------------|----------|
| Wire Striplength | 0.5 mm |
| Wire Length by Color | 12" |
| Wire Type | Stranded |
| Remote Wiring Configuration Allowed | Yes |
| Max Ballast-Lamp Distance Remote | 2' |
| Wiring | |

Core & Coil (71A) MH 175W - 450W

| | |
|-----------------------------------|---|
| Recommended Fuse Value | 10/7/5/5 A |
| Approval and Application | |
| Open Circuit Voltage Test (Volts) | 250-300 V |
| Approbation Marks | ULR CSA certificate EISA RoHS Compliant |
| Temperature Marking | A/B/A/A |
| UL Recognized | Yes |
| Hipot Test (1 Minute) | 2000 V |
| Hipot Test (2 Seconds) | 2500 V |
| UL Insulation Class | H(180°C) |
| UL Temperature Code | 1029B |

| | |
|---------------------------------|---|
| Product Data | |
| Order product name | CORE & COIL HID MH BAL 350W M131 QUAD C&C |
| EAN/UPC - Product | 781087070659 |
| Order code | 71A5993500DAEE |
| Numerator - Quantity Per Pack | 1 |
| Numerator - Packs per outer box | 4 |
| Material Nr. (12NC) | 913710666202 |
| Net Weight (Piece) | 5.503 kg |

Dimensional drawing

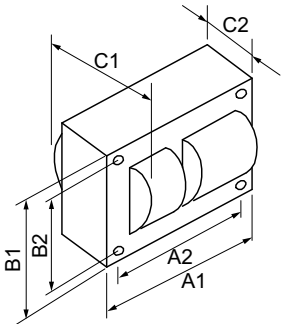

MH BAL 350W M131 QUAD C&C

| Product | C1 | C2 | A1 | A2 | B1 | B2 |
|--------------------------------|---------|---------|--------|--------|--------|--------|
| CORE & COIL HID 71A5993500DAEE | 4.05 in | 2.13 in | 4.8 in | 4.4 in | 4.3 in | 3.9 in |

