

Core & Coil (71A) MH 175W – 450W

CORE & COIL HID 71A5892600AEE

The basic ballast is the open core and coil which is most often used as a component within a lighting luminaire. The core and coil also forms the nucleus of Philips Advance's five other ballast configurations.

Product data

General Information			
ANSI Code	M132-M154	Input Frequency	60 Hz
Lamp Type	320W MH	Input Current (Open Circuit)	1.46/0.79/0.74/0.62 A
Number of Lamps	1 piece/unit	Input Current (Starting)	2.7/1.52/1.35/1.16 A
Circuit Type	SUPER-CWA	Input Current (Short Circuit)	2.16-3.24/1.21-1.82/1.08-1.62/0.93-1.39 A
Ballast Type	Magnetic HID	Secondary Short Circuit Current	2.9-3.6 A
Base Model	71A5892AEE	Constant Wattage Deviation	10%
Core Size	4 1/4 x 4 3/4 (2 coil)	Ballast Factor (Nom)	1
Suitable For Outdoor Use	Yes	Power Factor (Nom)	0.90
Ignitor Catalog Number	LI533-H4	Open Circuit Voltage	280 V
Ignitor Temperature Rating	105°C	Input Current (Nom)	3.25/1.9/1.65/1.4 A A
Capacitor Value	21 MFD	Input Power (Nom)	368 W
Capacitor Catalog Number	7C210P40R	Rated Lamp Power	320 W
Capacitor Requirements	400V	Wiring	
Capacitor Temperature Rating	105°C	Wire Striplength	0.5 mm
Capacitor Diameter/Oval Dimensions	1.75 in	Wire Length by Color	12"
Capacitor Height	4.80 in	Wire Type	Stranded
Automatic Restart	No	Remote Wiring Configuration Allowed	Yes
Operating and Electrical		Max Ballast-Lamp Distance Remote Wiring	2'
Input Voltage	120/208/240/277 V	Recommended Fuse Value	8/6/5/3 A

Core & Coil (71A) MH 175W - 450W

Approval and Application	
Open Circuit Voltage Test (Volts)	254-310 V
Approval Marks	ULR CSA certificate EISA RoHS Compliant
Temperature Marking	A/A/A/A
UL Recognized	Yes
Hipot Test (1 Minute)	2000 V
Hipot Test (2 Seconds)	2500 V
UL Insulation Class	H(180°C)
UL Temperature Code	1029A

Product Data	
Order product name	CORE & COIL HID 71A5892600AEE
EAN/UPC - Product	781087075197
Order code	913710673402
Numerator - Quantity Per Pack	1
Numerator - Packs per outer box	4
Material Nr. (12NC)	913710673402
Net Weight (Piece)	5.058 kg

Dimensional drawing

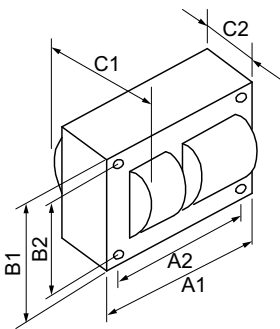

Product	C1	C2	A1	A2	B1	B2
CORE & COIL HID 71A5892600AEE	3.77 in	2.06 in	4.8 in	4.4 in	4.3 in	3.9 in

MH BAL 320W M132/M154 QUAD C&C

