



Core & Coil (71A) MH 175W – 450W

CORE & COIL HID 71A6092500DAEE

The basic ballast is the open core and coil which is most often used as a component within a lighting luminaire. The core and coil also forms the nucleus of Philips Advance's five other ballast configurations.

Product data

General Information			
ANSI Code	M135-M155	Input Frequency	60 Hz
Lamp Type	400W MH	Input Current (Open Circuit)	2.6/1.56/1.31/1.17 A
Number of Lamps	1 piece/unit	Input Current (Starting)	2.97/1.68/1.48/1.3 A
Circuit Type	SUPER-CWA	Input Current (Short Circuit)	2.4-3.6/1.4-2.1/1.2-1.8/1.05-1.55 A
Ballast Type	Magnetic HID	Secondary Short Circuit Current	3.6-4.5 A
Base Model	71A6092AEE	Constant Wattage Deviation	10%
Core Size	4 1/4 x 4 3/4 (2 coil)	Ballast Factor (Nom)	1
Suitable For Outdoor Use	Yes	Power Factor (Nom)	0.90
Ignitor Catalog Number	LI533-H4	Open Circuit Voltage	275 V
Ignitor Temperature Rating	105°C	Input Current (Nom)	3.8/2.2/1.9/1.65 A A
Capacitor Value	26 MFD	Input Power (Nom)	452 W
Capacitor Catalog Number	7C260P33R	Rated Lamp Power	400 W
Capacitor Requirements	330V	Wiring	
Capacitor Temperature Rating	105°C	Wire Striplength	0.5 mm
Capacitor Diameter/Oval Dimensions	1.75 in	Wire Length by Color	12"
Capacitor Height	4.80 in	Wire Type	Stranded
Automatic Restart	No	Remote Wiring Configuration Allowed	Yes
Operating and Electrical		Max Ballast-Lamp Distance Remote Wiring	2'
Input Voltage	120/208/240/277 V	Recommended Fuse Value	10/7/5/5 A

Core & Coil (71A) MH 175W - 450W

Approval and Application

Open Circuit Voltage Test (Volts)	248-302 V
Approval Marks	ULR CSA certificate EISA RoHS Compliant
Temperature Marking	D/D/D/D
UL Recognized	Yes
Hipot Test (1 Minute)	2000 V
Hipot Test (2 Seconds)	2500 V
UL Insulation Class	H(180°C)
UL Temperature Code	1029D

Product Data

Order product name	CORE & COIL HID 71A6092500DAEE
EAN/UPC - Product	781087075494
Order code	913710676102
Numerator - Quantity Per Pack	1
Numerator - Packs per outer box	4
Material Nr. (12NC)	913710676102
Net Weight (Piece)	5.512 kg

Dimensional drawing

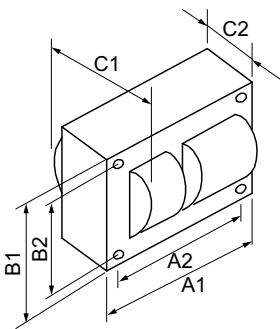

MH BAL 400W M135/155 QUAD C&C

Product	C1	C2	A1	A2	B1	B2
CORE & COIL HID 71A6092500DAEE	4.10 in	2.16 in	4.8 in	4.4 in	4.3 in	3.9 in

