

PHILIPS

Lighting



Core & Coil (71A) MH 175W - 450W

**CORE & COIL HID MH BAL 175W M137/M152 QUAD
C&C**

The basic ballast is the open core and coil which is most often used as a component within a lighting luminaire. The core and coil also forms the nucleus of Philips Advance's five other ballast configurations.

Product data

General Information	
ANSI Code	M137-M152
Lamp Type	175W MH
Number of Lamps	1 piece/unit
Circuit Type	SUPER-CWA
Ballast Type	Magnetic HID
Base Model	71A5593EE
Core Size	3 X 4 (2 coil)
Suitable For Outdoor Use	Yes
Ignitor Catalog Number	LI533-H4
Ignitor Temperature Rating	105°C
Capacitor Value	11 MFD
Capacitor Catalog Number	7C110M40
Capacitor Requirements	370V
Capacitor Temperature Rating	105°C
Capacitor Diameter/Oval Dimensions	1.65 in
Capacitor Height	3.75 in
Automatic Restart	No

Operating and Electrical	
Input Voltage	120/208/240/277 V
Input Frequency	60 Hz
Inp. Current (Open Circuit)	2.0/1.16/1.15/0.85 A
Input Current (Starting)	0.5/0.28/0.22/0.2 A
Input Current (Short Circuit)	0.4-0.6/0.23-0.34/0.17-0.26/0.16-0.25 A
Secondary Short Circuit Current	1.6-1.96 A
Constant Wattage Deviation	10%
Ballast Factor (Nom)	1
Power Factor (Nom)	0.90
Nominal Open Circuit Voltage	285 V
Input Current (Operating) (Nom)	1.78/1.08/0.89/0.76 A A
Input Power (Nom)	208 W
Rated Lamp Watts	175 W
Wiring	
Wire Striplength	0.5 mm
Wire Length by Color	12"
Wire Type	Stranded
Remote Wiring Configuration Allowed	Yes

Core & Coil (71A) MH 175W - 450W

Max Ballast-Lamp Distance Remote Wiring	2'
Recommended Fuse Value	5/3/3/2 A

Approval and Application

Open Circuit Voltage Test (Volts)	250-300 V
Approbation Marks	ULR CSA certificate EISA RoHS Compliant
Temperature Marking	A/A/A/A
UL Recognized	Yes
Hipot Test (1 Minute)	2000 V
Hipot Test (2 Seconds)	2500 V
UL Insulation Class	H(180°C)
UL Temperature Code	1029A

Product Data

Order product name	CORE & COIL HID 71A5593600EE
EAN/UPC - Product	781087075968
Order code	71A5593600EE
Numerator - Quantity Per Pack	1
Numerator - Packs per outer box	6
Material Nr. (12NC)	913710677502
Net Weight (Piece)	4.378 kg

Dimensional drawing

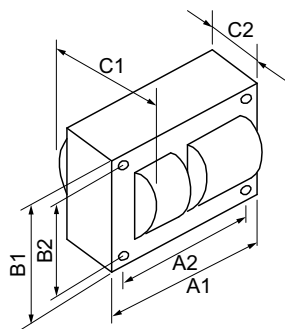

MH BAL 175W M137/M152 QUAD C&C

Product	C1	C2	A1	A2	B1	B2
CORE & COIL HID 71A5593600EE	4.41 in	3.20 in	3.9 in	3.5 in	2.8 in	2.4 in

