



Core & Coil (71A) MH ~LT~ 175W

CORE & COIL HID 71A5493600

The basic ballast is the open core and coil which is most often used as a component within a lighting luminaire. The core and coil also forms the nucleus of Philips Advance's five other ballast configurations.

Product data

| General Information | | | |
|------------------------------------|-------------------|---|--|
| ANSI Code | M102-M142 | Input Frequency | 60 Hz |
| Lamp Type | 150 MH | Input Current (Open Circuit) | 1.98/1/0.95/0.81 A |
| Number of Lamps | 1 piece/unit | Input Current (Starting) | 0.7/0.39/0.37/0.31 A |
| Circuit Type | SUPER-CWA | Input Current (Short Circuit) | 0.33-0.5/0.17-0.26/0.16-0.24/0.15-0.22 A |
| Ballast Type | Magnetic HID | Secondary Short Circuit Current | 1.9-2.35 A |
| Base Model | 71A5493 | Constant Wattage Deviation | 10% |
| Core Size | 3 X 4 (2 coil) | Ballast Factor (Nom) | 1 |
| Suitable For Outdoor Use | Yes | Power Factor (Nom) | 0.90 |
| Ignitor Catalog Number | LI501-J4 | Open Circuit Voltage | 217 V |
| Ignitor Temperature Rating | 105°C | Input Current (Nom) | 1.64/0.92/0.85/0.73 A A |
| Capacitor Value | 16 MFD | Input Power (Nom) | 190 W |
| Capacitor Catalog Number | 7C160M30RA | Rated Lamp Power | 150 W |
| Capacitor Requirements | 300V | Wiring | |
| Capacitor Temperature Rating | 105°C | Wire Striplength | 0.5 mm |
| Capacitor Diameter/Oval Dimensions | 1.65 in | Wire Length by Color | 12" |
| Capacitor Height | 2.75 in | Wire Type | Stranded |
| Automatic Restart | No | Remote Wiring Configuration Allowed | Yes |
| Operating and Electrical | | Max Ballast-Lamp Distance Remote Wiring | 5' |
| Input Voltage | 120/208/240/277 V | Recommended Fuse Value | 5/2.5/2/2 A |

Core & Coil (71A) MH ~LT~ 175W

| Approval and Application | |
|-----------------------------------|------------------------------------|
| Open Circuit Voltage Test (Volts) | 195-239 V |
| Approval Marks | ULR CSA certificate RoHS Compliant |
| Temperature Marking | D/C/D/C |
| UL Recognized | Yes |
| Hipot Test (1 Minute) | 1500 V |
| Hipot Test (2 Seconds) | 2500 V |
| UL Insulation Class | H(180°C) |
| UL Temperature Code | 1029D |

| Product Data | |
|---------------------------------|----------------------------|
| Order product name | CORE & COIL HID 71A5493600 |
| EAN/UPC - Product | 781087076965 |
| Order code | 913710692602 |
| Numerator - Quantity Per Pack | 1 |
| Numerator - Packs per outer box | 4 |
| Material Nr. (12NC) | 913710692602 |
| Net Weight (Piece) | 3.425 kg |

Dimensional drawing

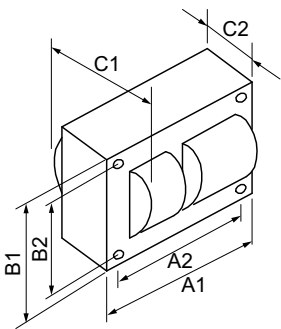

| Product | C1 | C2 | A1 | A2 | B1 | B2 |
|----------------------------|---------|---------|--------|--------|--------|--------|
| CORE & COIL HID 71A5493600 | 3.75 in | 2.40 in | 3.9 in | 3.5 in | 2.8 in | 2.4 in |

MH BAL 150W M102/142 QUAD C&C

