

Core & Coil (71A) MH ~LT~ 175W

CORE & COIL HID 71A5493510D

The basic ballast is the open core and coil which is most often used as a component within a lighting luminaire. The core and coil also forms the nucleus of Philips Advance's five other ballast configurations.

Product data

General Information			
ANSI Code	M102-M142	Input Frequency	60 Hz
Lamp Type	150 MH	Input Current (Open Circuit)	1.98/1/0.95/0.81 A
Number of Lamps	1 piece/unit	Input Current (Starting)	0.7/0.39/0.37/0.31 A
Circuit Type	SUPER-CWA	Input Current (Short Circuit)	0.33-0.5/0.17-0.26/0.16-0.24/0.15-0.22 A
Ballast Type	Magnetic HID	Secondary Short Circuit Current	1.9-2.35 A
Base Model	71A5493	Constant Wattage Deviation	10%
Core Size	3 X 4 (2 coil)	Ballast Factor (Nom)	1
Suitable For Outdoor Use	Yes	Power Factor (Nom)	0.90
Ignitor Catalog Number	LI501-J4	Open Circuit Voltage	217 V
Ignitor Temperature Rating	105°C	Input Current (Nom)	1.64/0.92/0.85/0.73 A A
Capacitor Value	16 MFD	Input Power (Nom)	190 W
Capacitor Catalog Number	7C160M30RA	Rated Lamp Power	150 W
Capacitor Requirements	300V	Wiring	
Capacitor Temperature Rating	105°C	Wire Striplength	0.5 mm
Capacitor Diameter/Oval Dimensions	1.65 in	Wire Length by Color	12"
Capacitor Height	2.75 in	Wire Type	Stranded
Automatic Restart	No	Remote Wiring Configuration Allowed	Yes
Operating and Electrical		Max Ballast-Lamp Distance Remote Wiring	5'
Input Voltage	120/208/240/277 V	Recommended Fuse Value	5/2.5/2/2 A

Core & Coil (71A) MH ~LT~ 175W

Approval and Application

Open Circuit Voltage Test (Volts)	195-239 V
Approval Marks	ULR CSA certificate RoHS Compliant
Temperature Marking	D/C/D/C
UL Recognized	Yes
Hipot Test (1 Minute)	1500 V
Hipot Test (2 Seconds)	2500 V
UL Insulation Class	H(180°C)
UL Temperature Code	1029D

Product Data

Order product name	CORE & COIL HID 71A5493510D
EAN/UPC - Product	781087077054
Order code	913710693502
Numerator - Quantity Per Pack	1
Numerator - Packs per outer box	4
Material Nr. (12NC)	913710693502
Net Weight (Piece)	3.616 kg

Dimensional drawing

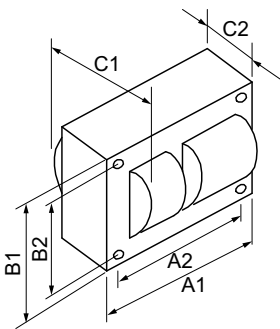

MH BAL 150W M102/142 QUAD C&C

Product	C1	C2	A1	A2	B1	B2
CORE & COIL HID 71A5493510D	3.75 in	2.40 in	3.9 in	3.5 in	2.8 in	2.4 in

