



Core & Coil (71A) MH 175W - 450W

CORE & COIL HID 71A6343500DTEE

The basic ballast is the open core and coil which is most often used as a component within a lighting luminaire. The core and coil also forms the nucleus of Philips Advance's five other ballast configurations.

Product data

General Information	
ANSI Code	M144
Lamp Type	450W MH
Number of Lamps	1 piece/unit
Circuit Type	SUPER-CWA
Ballast Type	Magnetic HID
Base Model	71A6343TEE
Core Size	4 1/4 x 4 3/4 (2 coil)
Suitable For Outdoor Use	Yes
Ignitor Catalog Number	LI533-H4
Ignitor Temperature Rating	105°C
Capacitor Value	26.5 MFD
Capacitor Catalog Number	7C265P40R
Capacitor Requirements	360V
Capacitor Temperature Rating	105°C
Capacitor Diameter/Oval Dimensions	1.75 in
Capacitor Height	4.80 in
Automatic Restart	No
Operating and Electrical	
Input Voltage	480/120T V

Input Frequency	60 Hz
Input Current (Open Circuit)	0.7 A
Input Current (Starting)	0.65 A
Input Current (Short Circuit)	0.5-0.75 A
Secondary Short Circuit Current	3.85-4.75 A
Constant Wattage Deviation	10%
Ballast Factor (Nom)	1
Power Factor (Nom)	0.90
Open Circuit Voltage	267 V
Input Current (Nom)	1.1 A A
Input Power (Nom)	514 W
Rated Lamp Power	450 W
Wiring	
Wire Striplength	0.5 mm
Wire Length by Color	12"
Wire Type	Stranded
Remote Wiring Configuration Allowed	Yes
Max Ballast-Lamp Distance Remote Wiring	5'
Recommended Fuse Value	3 A

Core & Coil (71A) MH 175W - 450W

Approval and Application

Open Circuit Voltage Test (Volts)	240-295 V
Approval Marks	ULR CSA certificate EISA RoHS Compliant
Temperature Marking	D
UL Recognized	Yes
Hipot Test (1 Minute)	2000 V
Hipot Test (2 Seconds)	2500 V
UL Insulation Class	H(180°C)
UL Temperature Code	1029D

Product Data

Order product name	CORE & COIL HID 71A6343500DTEE
EAN/UPC - Product	781087077634
Order code	913710699002
Numerator - Quantity Per Pack	1
Numerator - Packs per outer box	4
Material Nr. (12NC)	913710699002
Net Weight (Piece)	6.564 kg

Dimensional drawing

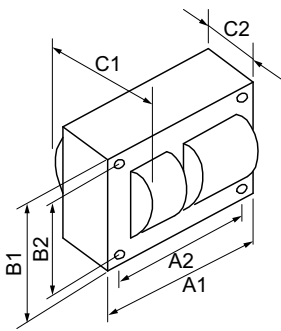

MH BAL 450W M144 480V/120T C&C

Product	C1	C2	A1	A2	B1	B2
CORE & COIL HID 71A6343500DTEE	4.15 in	2.40 in	4.8 in	4.4 in	4.3 in	3.9 in

