

# HID-Basic Semi-Parallel ballasts for MHN/CDM lamps

## BMHA 70L 300I TS

The HID Basic Semi-Parallel ballast is an impregnated (HID standard) electromagnetic copper/iron ballast for use with an external ignitor for metal-halide and CDM lamps.

### Product data

<b>Operating and Electrical</b>		<b>Order product name</b>	
Input Voltage	220 V	Order code	913713016044
Line Frequency	50 Hz	Numerator - Quantity Per Pack	1
Input Frequency	50 Hz	Numerator - Packs per outer box	6
<b>Wiring</b>		Material Nr. (12NC)	913713016044
Connector Type	Screw	Full product name	BMHA 70L 300I TS
<b>Approval and Application</b>		EAN/UPC - Case	6948182299413
Approval Marks	CE marking CCC certificate	EAN/UPC - Product/Case	6948182295811
<b>Product Data</b>			
Full product code	694818229941300		

HID-Basic Semi-Parallel ballasts for MHN/CDM lamps

Dimensional drawing

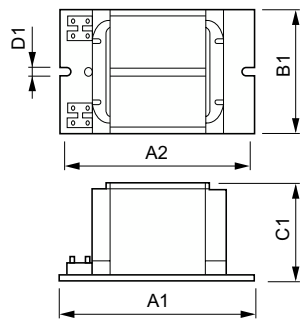

Product	D1	C1	A1	A2	B1
BMHA 70L 300I TS	6.2 mm	51.5 mm	110.0 mm	95.0 mm	57.1 mm

