



# HF-Selectalume II for TL-D lamps

## HF-S 3/4 18 TL-D II 220-240V 50/60Hz

HF-Selectalume II is the most cost-effective, reliable, slim and affordable fluorescent solution, with highly disruptive technology for energy saving, system flexibility and unsurpassed performance. The cost-saving HF-Selectalume II has a robust design which meets all relevant international safety and performance standards. HF-Selectalume II is intended for use with indoor lighting fixtures such as spotlights, downlights and recessed luminaires, which are largely used in office, retail, industry, hotel, restaurant and other applications where control devices are installed with occasional On/Off switching activity

### Product data

Operating and Electrical	
Input Voltage	220 to 240 V
Line Frequency	50 to 60 Hz
Input Frequency	50 to 60 Hz
Earth Leakage Current (Max)	0.5 mA
Inrush Current Width	0.35 ms
Inrush Current Peak (Max)	18 A
Number of Products on MCB (16A Type B) (Nom)	
Wiring	
Connector Type Input Terminals	WAGO 744 connector
Connector Type Output Terminals	WAGO 744 connector [Suitable for manual wiring]
Temperature	
Ambient temperature range	-20 °C to 50 °C

T-Case Lifetime (Nom)	75 °C
T-Case Maximum (Max)	75 °C
Mechanical and Housing	
Housing	L 280x39x28
Approval and Application	
Ingress protection code	IP20 [Finger-protected]
Energy Efficiency Index	A2/A2 BAT
Approval Marks	F-Marking CE marking ENEC certificate CCC certificate C-Tick certificate PSB certification TISI marking SIRIM approval CB Certificate CCC certificate VDE-EMV certificate
Product Data	
Order product name	HF-S 3/4 18 TL-D II 220-240V 50/60Hz
Full product name	HF-S 3/4 18 TL-D II 220-240V 50/60Hz

# HF-Selectalume II for TL-D lamps

Full product code	872790090555700
Order code	913713032666
Material Nr. (12NC)	913713032666
Numerator - Quantity Per Pack	1
EAN/UPC - Product/Case	8711500999320

Numerator - Packs per outer box	10
EAN/UPC - Case	8727900905557

## Dimensional drawing

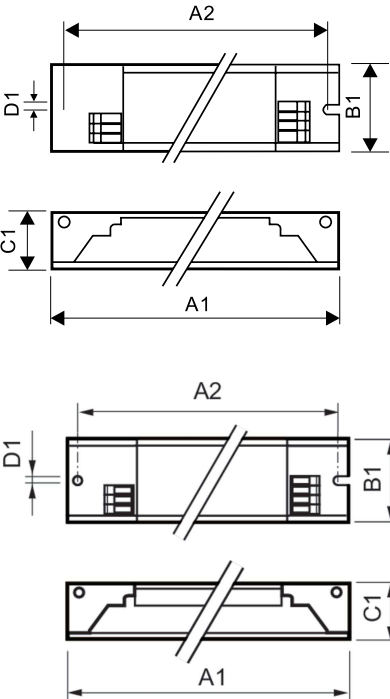

Product	HF-S 3/4 18 TL-D II 220-240V 50/60Hz
---------	--------------------------------------

Product	A1	B1	C1	A2	B2	D1
HF-S 3/4 18 TL-D II 220-240V 50/60Hz	280 mm	39 mm	28 mm	265 mm		4.2 mm

