



# HF-Selectalume II for TL5 lamps

## HF-S 124/39 TL5 II 220-240V 50/60Hz

HF-Selectalume II TL5 is the most cost-effective, reliable and outstanding solution for fluorescent lamps. These ballasts are part of an overall high-efficiency lighting system that may help you or your customers to achieve any international or local energy code you need to comply with. HF-Selectalume II TL5 ballasts are the ideal choice for a broad range of new construction and retrofit applications within the commercial sector, including general surface mounting or office lighting, parking garages, warehouses, waterproof and other applications.

### Product data

Operating and Electrical		Mechanical and Housing	
Input Voltage	220 to 240 V	Housing	L 280x30x21.5
Line Frequency	50 to 60 Hz		
Input Frequency	50 to 60 Hz	Approval and Application	
Earth Leakage Current (Max)	0.5 mA	Ingress protection code	IP20 [Finger-protected]
Inrush Current Width	0.28 ms	Energy Efficiency Index	A2/A2 BAT
Inrush Current Peak (Max)	20 A	Approval Marks	F-Marking CE marking ENEC certificate CCC certificate C-Tick certificate PSB certification TISI marking SIRIM approval CB Certificate CCC certificate VDE-EMV certificate
Wiring		Product Data	
Connector Type Input Terminals	WAGO 744 connector	Order product name	HF-S 124-39 TL5 II 220-240V 50/60Hz
Connector Type Output Terminals	WAGO 744 connector [Suitable for manual wiring]	Full product name	HF-S 124/39 TL5 II 220-240V 50/60Hz
Temperature		Full product code	872790093933000
Ambient temperature range	-15 °C to 50 °C	Order code	93933000
T-Case Lifetime (Nom)	75 °C	Material Nr. (12NC)	913713034466
T-Case Maximum (Max)	75 °C	Numerator - Quantity Per Pack	1

# HF-Selectalume II for TL5 lamps

EAN/UPC - Product/Case	8727900939330
Numerator - Packs per outer box	12
EAN/UPC - Case	8727900939347

## Dimensional drawing

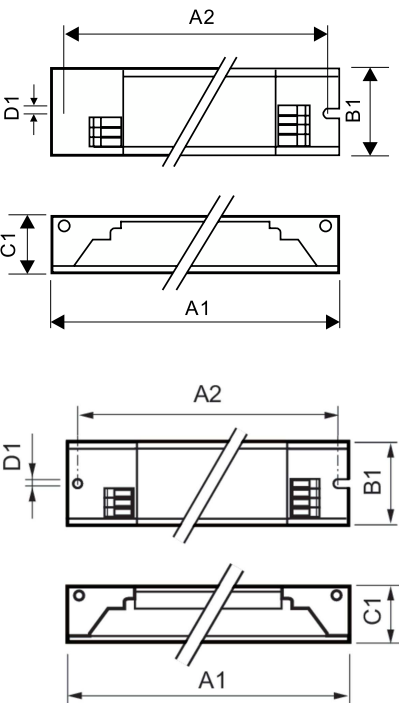

Product
HF-S 124-39 TL5 II 220-240V 50/60Hz

Product	A1	B1	C1	A2	B2	D1
HF-S 124-39 TL5 II 220-240V 50/60Hz	280 mm	30 mm	21.5 mm	265 mm		4.2 mm

