



# HF-Selectalume II for TL5 lamps

## HF-S 124-39 TL5 II 220-240V 50/60Hz

HF-Selectalume II TL5 is the most cost-effective, reliable and outstanding solution for fluorescent lamps. These ballasts are part of an overall high-efficiency lighting system that may help you or your customers to achieve any international or local energy code you need to comply with. HF-Selectalume II TL5 ballasts are the ideal choice for a broad range of new construction and retrofit applications within the commercial sector, including general surface mounting or office lighting, parking garages, warehouses, waterproof and other applications. The ballast is primarily designed for Indoor application. For outdoor application, the luminaire should be minimum Classland need to be sufficiently protected against water & dust. The installation should also be guard against any lightening surge or any other necessary electrical protection as deemed in such typical installation & application.

### Product data

Operating and Electrical	
Input Voltage	220 to 240 V
Line Frequency	50 to 60 Hz
Input Frequency	50 to 60 Hz
Earth Leakage Current (Max)	0.5 mA
Inrush Current Width	0.28 ms
Inrush Current Peak (Max)	20 A
Wiring	
Connector Type Input Terminals	WAGO 744 connector
Connector Type Output Terminals	WAGO 744 connector [Suitable for manual wiring]
Temperature	
Ambient temperature range	-15 °C to 50 °C

T-Case Lifetime (Nom)	75 °C
T-Case Maximum (Max)	75 °C
Mechanical and Housing	
Housing	L 280x30x21.5
Approval and Application	
Ingress protection code	IP20 [Finger-protected]
Energy Efficiency Index	A2/A2 BAT
Approval Marks	F-Marking CE marking ENEC certificate CCC certificate C-Tick certificate PSB certification TISI marking SIRIM approval CB Certificate CCC certificate VDE-EMV certificate

# HF-Selectalume II for TL5 lamps

Product Data	
Order product name	HF-S 124-39 TL5 II 220-240V 50/60Hz
Full product name	HF-S 124-39 TL5 II 220-240V 50/60Hz
Full product code	872790093933000
Order code	913713034466
Material Nr. (12NC)	913713034466

Numerator - Quantity Per Pack	1
EAN/UPC - Product/Case	8727900939330
Numerator - Packs per outer box	12
EAN/UPC - Case	8727900939347

## Dimensional drawing

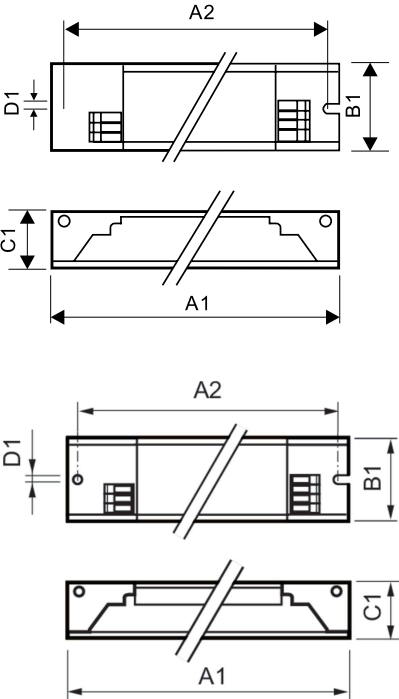

Product
HF-S 124-39 TL5 II 220-240V 50/60Hz

Product	A1	B1	C1	A2	B2	D1
HF-S 124-39 TL5 II 220-240V 50/60Hz	280 mm	30 mm	21.5 mm	265 mm		4.2 mm

