



HF-Selectalume II for TL5 lamps

HF-S 3/424 TL5 II 220-240V 50/60Hz

HF-Selectalume II TL5 is the most cost-effective, reliable and outstanding solution for fluorescent lamps. These ballasts are part of an overall high-efficiency lighting system that may help you or your customers to achieve any international or local energy code you need to comply with. HF-Selectalume II TL5 ballasts are the ideal choice for a broad range of new construction and retrofit applications within the commercial sector, including general surface mounting or office lighting, parking garages, warehouses, waterproof and other applications. The ballast is primarily designed for Indoor application. For outdoor application, the luminaire should be minimum Classland need to be sufficiently protected against water & dust. The installation should also be guard against any lightening surge or any other necessary electrical protection as deemed in such typical installation & application.

Product data

Operating and Electrical		Connector Type Output Terminals	
Input Voltage	220 to 240 V	WAGO 744 connector [Suitable for manual wiring]	
Line Frequency	50 to 60 Hz		
Input Frequency	50 to 60 Hz	Temperature	
Earth Leakage Current (Max)	0.5 mA	Ambient temperature range	
Inrush Current Width	0.35 ms	-15 °C to 50 °C	
Inrush Current Peak (Max)	30 A	T-Case Lifetime (Nom)	
Number of Products on MCB (16A Type B) (Nom)	15	75 °C	
		T-Case Maximum (Max)	
		75 °C	
		Mechanical and Housing	
		Housing	
		L 280x39x21.5	
		Approval and Application	
		Ingress protection code	
		IP20 [Finger-protected]	
		Energy Efficiency Index	
		A2 BAT	

HF-Selectalume II for TL5 lamps

Approval Marks	F-Marking CE marking ENEC certificate CCC
	certificate C-Tick certificate PSB certification
	TISI marking SIRIM approval CB Certificate CCC
	certificate VDE-EMV certificate

Product Data	
Order product name	HF-S 3/424 TL5 II 220-240V 50/60Hz
Full product name	HF-S 3/424 TL5 II 220-240V 50/60Hz
Full product code	872790093937800

Order code	913713034666
Material Nr. (12NC)	913713034666
Numerator - Quantity Per Pack	1
EAN/UPC - Product/Case	8727900939378
Numerator - Packs per outer box	10
EAN/UPC - Case	8727900939385

Dimensional drawing

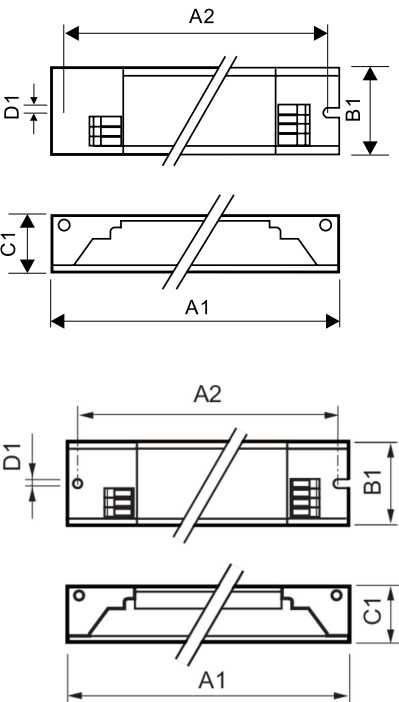

Product	
HF-S 3/424 TL5 II 220-240V 50/60Hz	

Product	A1	B1	C1	A2	B2	D1
HF-S 3/424 TL5 II 220-240V 50/60Hz	280 mm	39 mm	21.5 mm	265 mm		4.2 mm

