

# HF-Selectalume II for PL-T/C Strain Relief

## HF-S 126 PL-T/C/L/TL5C II SR 220-240V

HF-Selectalume II independent version is the most cost-effective, reliable, slim and affordable fluorescent solution, with highly disruptive technology for energy saving, system flexibility and unsurpassed performance. The cost-saving HF-Selectalume II PLTC SR has a robust design which meets all relevant international safety and performance standards. The HF-S II strain relief is optimized mainly for PL-T/C lamps. HF-Selectalume II is intended for use with indoor lighting fixtures such as spotlights, downlights and recessed luminaries, which are largely used in office, retail, industry, hotel, restaurant and other applications.

### Product data

Operating and Electrical	
Input Voltage	220 to 240 V
Line Frequency	50 to 60 Hz
Input Frequency	50 to 60 Hz
Earth Leakage Current (Max)	0.7 mA
Inrush Current Width	0.23 ms
Inrush Current Peak (Max)	11.5 A
Number of Products on MCB (16A Type B) (Nom)	35
Wiring	
Connector Type Input Terminals	WAGO 250 connector [Suitable for manual wiring]
Connector Type Output Terminals	WAGO 250 connector [Suitable for manual wiring]

Temperature	
Ambient temperature range	-10 °C to 50 °C
T-Case Lifetime (Nom)	70 °C
T-Case Maximum (Max)	70 °C
Mechanical and Housing	
Housing	L 125.5x67.8x32.0
Approval and Application	
Ingress protection code	IP20 [Finger-protected]
Energy Efficiency Index	A2
Approval Marks	PSG CE marking CCC certificate C-Tick certificate SIRIM approval KEMA Keur certificate CCC certificate

Product Data	
Order product name	HF-S 126 PL-T/C/L/TL5C II SR 220-240V

# HF-Selectalume II for PL-T/C Strain Relief

Full product name	HF-S 126 PL-T/C/L/TL5C II SR 220-240V
Full product code	871829116961100
Order code	16961100
Material Nr. (12NC)	913713035766
Numerator - Quantity Per Pack	1

EAN/UPC - Product/Case	8718291169611
Numerator - Packs per outer box	12
EAN/UPC - Case	8718291169628

## Dimensional drawing

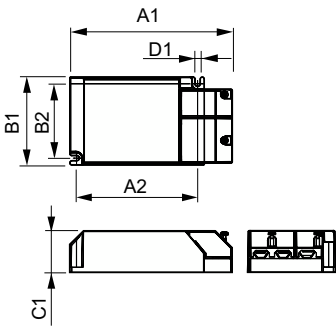

Product	D1	C1	A1	A2	B1	B2
HF-S 126 PL-T/C/L/TL5C II SR 220-240V	4.0 mm	32.0 mm	125.5 mm	93.5 mm	67.8 mm	57.5 mm

