



HF-Essential for TL5/TL-D

HF-E 118 TL-D 220-240 50/60Hz

Essentially smart and reliable. HF-Essential is the most cost-effective, slim and affordable ballast to reliably operate a fluorescent lamp. It is also the ideal entry-level product for EM system users who want to enjoy the benefits offered by electronic ballasts. The cost-saving and reliable HF-Essential has an energy efficiency class A2, and its robust design meets all relevant international safety and performance standards. HF-Essential is intended for use with indoor lighting fixtures such as recessed luminaires, which are largely used in office, industrial, hotel, restaurant and other applications.

Product data

Operating and Electrical	
Input Voltage	220 to 240 V
Line Frequency	50 to 60 Hz
Input Frequency	50 to 60 Hz
Earth Leakage Current (Max)	0.5 mA
Inrush Current Width	0.37 ms
Inrush Current Peak (Max)	15 A
Wiring	
Connector Type Input Terminals	Insert
Connector Type Output Terminals	Insert
Temperature	
Ambient temperature range	-10 °C to 50 °C
T-Case Lifetime (Nom)	75 °C
T-Case Maximum (Max)	75 °C

Mechanical and Housing	
Housing	L 150x40x28
Approval and Application	
Ingress protection code	IP20 [Finger-protected]
Energy Efficiency Index	A2
Approval Marks	CE marking C-Tick certificate CB Certificate KEMA Keur certificate RoHS Compliant
Product Data	
Order product name	HF-E 118 TL-D 220-240 50/60Hz
Full product name	HF-E 118 TL-D 220-240 50/60Hz
Full product code	871829166865700
Order code	66865700
Material Nr. (12NC)	913713038766
Numerator - Quantity Per Pack	1
EAN/UPC - Product/Case	8718291668657

HF-Essential for TL5/TL-D

Numerator - Packs per outer box	20
EAN/UPC - Case	8718291668664

Dimensional drawing

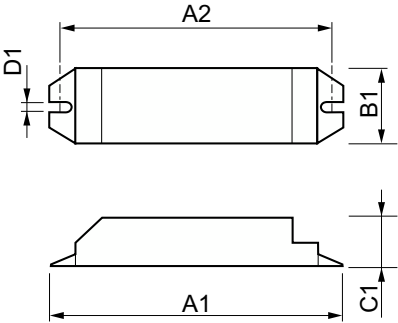

Product	D1	C1	A1	A2	B1
HF-E 118 TL-D 220-240 50/60Hz	4.2 mm	28.0 mm	150.0 mm	136.0 mm	40.0 mm

