



HF-Essential for TL5/TL-D

HF-E 158 TL-D 220-240 50/60Hz

HF-Essential is the most cost-effective, slim and affordable ballast to reliably operate a fluorescent lamp. It is also the ideal entry-level product for EM system users who want to enjoy the benefits offered by electronic ballasts. The cost-saving and reliable HF-Essential has an energy efficiency class A2, and its robust design meets all relevant international safety and performance standards. HF-Essential is intended for use with indoor lighting fixtures such as recessed luminaires, which are largely used in office, industrial, hotel, restaurant and other applications.

Product data

Operating and Electrical		Energy Efficiency Index	
Input Voltage	220 to 240 V	A2	
Line Frequency	50 to 60 Hz	Approval Marks	
Input Frequency	50 to 60 Hz	CE marking C-Tick certificate CB Certificate KEMA	
Earth Leakage Current (Max)	0.5 mA	Keur certificate RoHS Compliant	
Inrush Current Width	0.24 ms	Product Data	
Inrush Current Peak (Max)	15 A	Order product name	
Wiring		HF-E 158 TL-D 220-240 50/60Hz	
Connector Type Input Terminals	Insert	Full product name	
Connector Type Output Terminals	Insert	HF-E 158 TL-D 220-240 50/60Hz	
Temperature		Full product code	
Ambient temperature range	-10 °C to 50 °C	871829166869500	
T-Case Lifetime (Nom)	75 °C	Order code	
T-Case Maximum (Max)	75 °C	913713038966	
Approval and Application		Material Nr. (12NC)	
Ingress protection code	IP20 [Finger-protected]	913713038966	
		Numerator - Quantity Per Pack	
		1	
		EAN/UPC - Product/Case	
		8718291668695	
		Numerator - Packs per outer box	
		50	
		EAN/UPC - Case	
		8718291668701	

HF-Essential for TL5/TL-D

Dimensional drawing

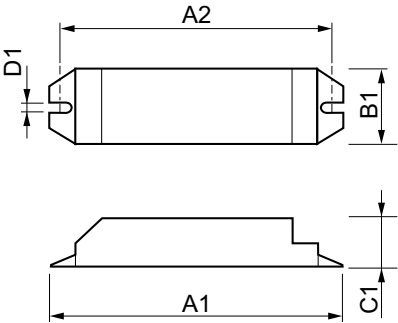

Product	D1	C1	A1	A2	B1
HF-E 158 TL-D 220-240 50/60Hz	4.2 mm	28.0 mm	150.0 mm	136.0 mm	40.0 mm

