



HF-Essential for TL5/TL-D

HF-E 128 TL5 220-240 50/60Hz

HF-Essential is the most cost-effective, slim and affordable ballast to reliably operate a fluorescent lamp. It is also the ideal entry-level product for EM system users who want to enjoy the benefits offered by electronic ballasts. The cost-saving and reliable HF-Essential has an energy efficiency class A2, and its robust design meets all relevant international safety and performance standards. HF-Essential is intended for use with indoor lighting fixtures such as recessed luminaires, which are largely used in office, industrial, hotel, restaurant and other applications.

Product data

Operating and Electrical		Mechanical and Housing	
Input Voltage	220 to 240 V	Housing	L 275x19.6x21.3
Line Frequency	50 to 60 Hz		
Input frequency	50 to 60 Hz	Approval and Application	
Earth leakage current (max.)	0.5 mA	Ingress protection code	IP20 [Finger-protected]
Inrush current width	0.3 ms	Energy efficiency index	A2
Inrush current peak (max.)	12 A	Approval marks	CE marking C-Tick certificate CB Certificate KEMA Keur certificate RoHS Compliant
Wiring		Product Data	
Connector type input terminals	Insert	Order product name	HF-E 128 TL5 220-240 50/60Hz
Connector type output terminals	Insert	Full product name	HF-E 128 TL5 220-240 50/60Hz
Temperature		Full EOC	871829166883100
Ambient temperature range	0 °C to 50 °C	Order code	66883100
T-case lifetime (nom.)	75 °C	Material no. (12 NC)	913713039566
T-Case maximum (max.)	75 °C	Local order code	HFE1-28TL5
		SAP numerator – quantity per pack	1
		EAN/UPC – Product/Case	8718291668831

HF-Essential for TL5/TL-D

Numerator – packs per outer box	50
EAN/UPC - Case	8718291668848

Dimensional drawing

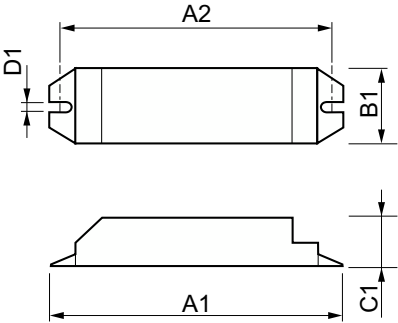

Product	D1	C1	A1	A2	B1
HF-E 128 TL5 220-240 50/60Hz	4.2 mm	21.3 mm	275.0 mm	263.0 mm	19.6 mm

