



# HF-Essential II for TL5/TL-D

## HF-E 214 TL5 II 220-240V 50/60Hz

Essentially smart and reliable. HF-Essential II is the most cost-effective solution for reliably operation of a fluorescent lamp. It is also the ideal entry-level product for electromagnetic system users who want to take advantage of the benefits provided by electronic ballasts. The cost-saving and reliable HF-Essential II is energy efficiency class A2, and its robust design meets all relevant international safety and performance standards. HF- Essential II is the ideal choice for a broad range of new construction and retrofit applications within the commercial sector, including general surface mounting and office lighting, parking garages, warehouses and other applications. The ballast is primarily designed for Indoor application. For outdoor application, the luminaire should be minimum Classland need to be sufficiently protected against water & dust. The installation should also be guard against any lightening surge or any other necessary electrical protection as deemed in such typical installation & application.

### Product data

Operating and Electrical	
Input Voltage	220 to 240 V
Line Frequency	50 to 60 Hz
Input Frequency	50 to 60 Hz
Earth Leakage Current (Max)	0.5 mA
Inrush Current Width	0.12 ms
Inrush Current Peak (Max)	11.93 A
Number of Products on MCB (16A Type B) (Nom)	30
Wiring	
Connector Type Input Terminals	Insert

Connector Type Output Terminals	Insert
Temperature	
Ambient temperature range	0 °C to 50 °C
T-Case Lifetime (Nom)	75 °C
T-Case Maximum (Max)	75 °C
Mechanical and Housing	
Housing	L 280x29.3x26
Approval and Application	
Ingress protection code	IP20 [Finger-protected]

HF-Essential II for TL5/TL-D

Energy Efficiency Index	A2
Approval Marks	CE marking KEMA Keur certificate RoHS Compliant
Product Data	
Full product code	871869641699000
Order product name	HF-E 214 TL5 II 220-240V 50/60Hz
Order code	913713041566

Numerator - Quantity Per Pack	1
Numerator - Packs per outer box	50
Material Nr. (12NC)	913713041566
Full product name	HF-E 214 TL5 II 220-240V 50/60Hz
EAN/UPC - Case	8718696417003
EAN/UPC - Product/Case	8718696416990

Dimensional drawing

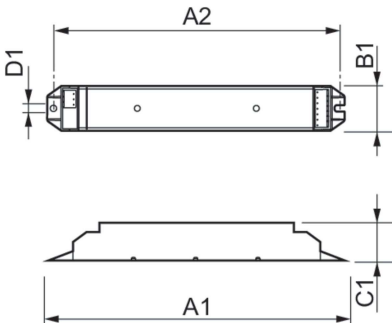

Product	D1	C1	A1	A2	B1
HF-E 214 TL5 II 220-240V 50/60Hz	4.2 mm	26.0 mm	280.0 mm	270.0 mm	29.3 mm

