

# HID-Basic Semi-Parallel ballasts for MHN/CDM lamps

## BMH 35L 300I TS

The HID Basic Semi-Parallel ballast is an impregnated (HID standard) electromagnetic copper/iron ballast for use with an external ignitor for metal-halide and CDM lamps.

### Product data

Operating and Electrical	
Input Voltage	220 V
Line Frequency	50 Hz
Input Frequency	50 Hz

Wiring	
Connector Type	Screw

Approval and Application	
Approval Marks	CE marking ENEC certificate CCC certificate

Product Data	
Order product name	BMH 35L 300I TS

Full product name	BMH 35L 300I TS
Full product code	697480505103800
Order code	913713200567
Material Nr. (12NC)	913713200567
Numerator - Quantity Per Pack	1
EAN/UPC - Product/Case	6974805051038
Numerator - Packs per outer box	6
EAN/UPC - Case	6974805051045

## HID-Basic Semi-Parallel ballasts for MHN/CDM lamps

### Dimensional drawing

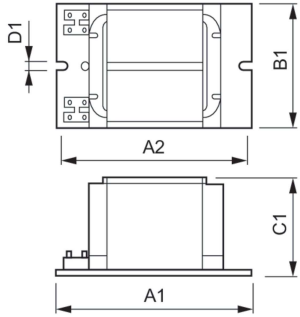

Product	D1	C1	A1	A2	B1
BMH 35L 300I TS	6.2 mm	51.5 mm	117.0 mm	102.0 mm	57.1 mm

