



# HDK472/473/474

## HDK472 SON400W SGR 220V-60HZ

SON, 400 W, SON gear, 220 V, 60 Hz

This modular range of high-bay industrial HDK luminaires is ideal for use in large indoor areas and is designed to work with 250 or 400 W sodium, metal-halide or mercury vapor lamps. Produced with high-quality materials, it offers two reflector options: open (GDK472) or closed (GDK473), and may be accompanied with a glass front (GDK472 PG or GDK473 PG), depending on the reflector. The HDK472/473 model features a tube suspension system (ZDK472 SPR), or track/rail (ZDKEH 473). The HDK474 model is made of cast aluminum, for use without ballast housing.

### Product data

General Information	
Lamp family code	SON [SON]
Gear	SGR [SON gear]

Operating and Electrical	
Input Voltage	220 V
Line Frequency	60 Hz
Power Consumption	400 W

Product Data	
Order product name	HDK472 SON400W SGR 220V-60HZ

Full product name	HDK472 SON400W SGR 220V-60HZ
Full product code	919506070469
Order code	919506070469
Material Nr. (12NC)	919506070469
Numerator - Quantity Per Pack	1
EAN/UPC - Product/Case	7894400001391
Numerator - Packs per outer box	1
EAN/UPC - Case	7894400001391

## HDK472/473/474

### Dimensional drawing

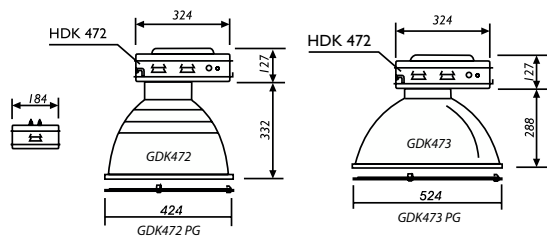

HDK 472 + GDK

